

GFX and XCN

DISPLAY SYSTEMS

CABLING GUIDE

Corporate Office

10368 Westmoor Drive
Westminster, CO 80021
USA

Agriculture Business Area

Trimble Inc.
Trimble Agriculture Division
10368 Westmoor Drive
Westminster, CO 80021
USA
trimble.com

Legal Notices

© 2022-2024, Trimble Inc. All rights reserved.

Trimble, the Globe & Triangle logo, EZ-Pilot, EZ-Steer, and FmX are trademarks of Trimble Inc., registered in the United States Patent and Trademark Office and/or other countries.

Autopilot, CFX-750, Field-IQ, FM-750, FM-1000, GFX-350, GFX-750, GFX-1060, GFX-1260, NAV-500, XCN-750, XCN-1050, XCN-1060, XCN-1260, and XCN-2050 are trademarks of Trimble Inc.

All other trademarks are the property of their respective owners.

Release Notice

This is the February 2024 release (Revision A) of the GFX and XCN Display Systems Cabling Guide.

This product is protected by US and international copyright, trademark, and patent law as described in "Legal Notices" in the *NAV-900 Guidance Controller Installation Guide*. Please refer to that manual for information on product warranties, and device notices.

Introduction

This cabling guide describes various installation scenarios for the NAV-500™ and NAV-900 guidance controller for GFX and XCN display series. The GFX/XCN series of displays are in-cab touch screen displays that provide affordable guidance, steering and precision agriculture functionality.

NOTE – The GFX and XCN series include the GFX-350™ / GFX-750™ / GFX-1060™ / GFX-1260™ and the XCN-750™ / XCN-1050™ / XCN-1060™ / XCN-1260™ (the XCN-2050™ is not covered in this guide).

1.1 Technical assistance

Go to the [Ag Resource Center](#) for the latest support information, including:

- support notes detailing support issues
- documentation
- the latest files available for download

If you still cannot find the information that you need, contact your Trimble reseller.

Cabling Diagrams

- Basic setup (manual guidance) with NAV-500 or NAV-900 guidance controller
- EZ-Steer with NAV-500 or NAV-900 guidance controller
- EZ-Pilot Pro with SAM-300 and NAV-500 guidance controller
- EZ-Pilot Pro and Autopilot Motor Drive with SAM-300 and NAV-900 guidance controller
 - Standard cabling
 - SAM-300 adapter cable for SAM-200 wiring harness
 - SAM-200 adapter cable using SAM-300 wiring harness
- Autopilot CAN Steer (on-roof connection) with NAV-900 guidance controller
- Autopilot (using NavController II/III) as an external guidance device with NAV-900 guidance controller
- Autopilot CNH, AGR – CAN with NAV-900 guidance controller
- Autopilot CNH Hybrid with NAV-900 guidance controller
- Autopilot using VDM-912 valve driver and NAV-900 guidance controller
- Field-IQ with NAV-500 or NAV-900 guidance controller
- Field-IQ – Full harness with NAV-500 or NAV-900 guidance controller
- GFX display – Basic set up (ISOBUS terminal)
- GFX display with ISOBUS Universal Terminal only
- ISOBUS Universal Terminal – In-cab connector with NAV-500 or NAV-900 guidance controller
- ISOBUS Universal Terminal – In-cab connector with switch boxes with NAV-500 or NAV-900 guidance controller
- ISOBUS Universal Terminal – Full harness with NAV-500 or NAV-900 guidance controller
- ISOBUS Universal Terminal with switch boxes with NAV-500 or NAV-900 guidance controller
- Expansion port 1 – Multi-use cable for Video In (1), Serial Rate/TUVR, Radar In and Imp Lift (coverage) switch
- Expansion port 2 – Cable for Video In only (1)
- Expansion port 2 – Cables for CAN TBC (1) - Field-IQ or ISOBUS
- Expansion port 1 & 2 – Cables for Video In (2) - Two Cameras
- Expansion port 2 – Cables for Video In (1) plus CAN TBC (1) - Camera plus ISOBUS or Field- IQ
- Expansion port 2 – Cables for FarmStream
- Expansion port 2 – Cables for CAN TBC (1) and FarmStream - ISOBUS Universal Terminal (with switch boxes) plus FarmStream
- Ag-820 radio with NAV-900 guidance controller
- External RTK radio with NAV-900 guidance controller

2.1 Basic setup (manual guidance) with NAV-500 or NAV-900 guidance controller

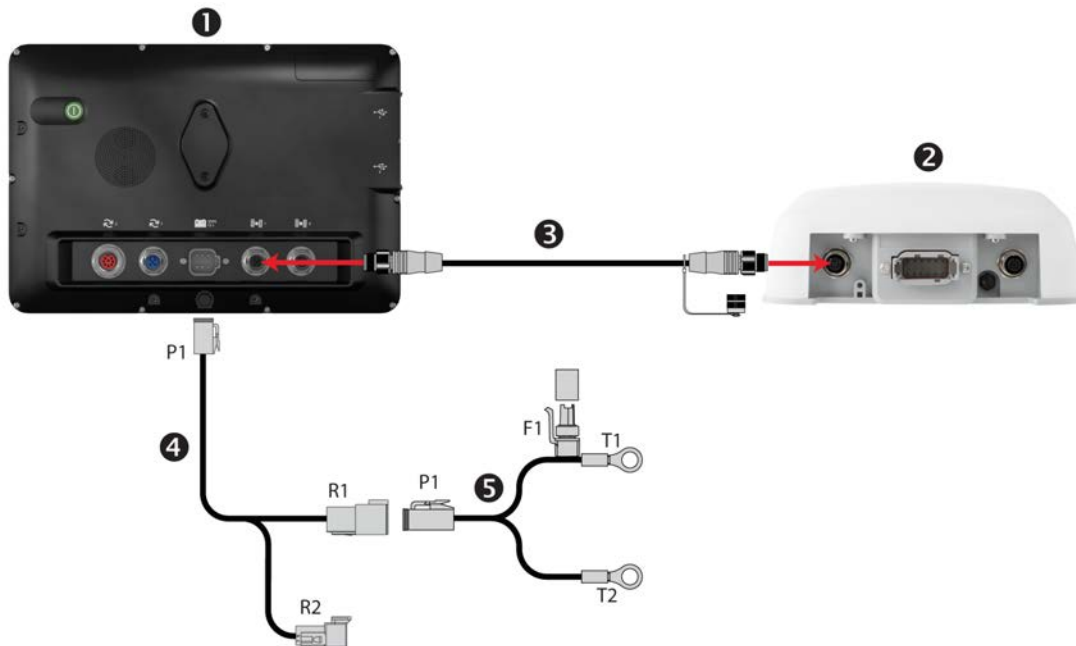

Item	Description	P/N
1	GFX/XCN series displays with PIQ app	
2	NAV-900 or NAV-500 guidance controller	
3	Cable Assy, GFX/XCN to NAV-500/900, Power/Ethernet (BRR), 5 m	110540
4	Cable Assy, GFX/XCN, Power to display, CAN, 2.5 m	110551
5	Cable Assy, GFX/CFX/FM-750/XCN/FMX/FM-1000 Basic power, 4 m	67258

2.2 EZ-Steer with NAV-500 or NAV-900 guidance controller

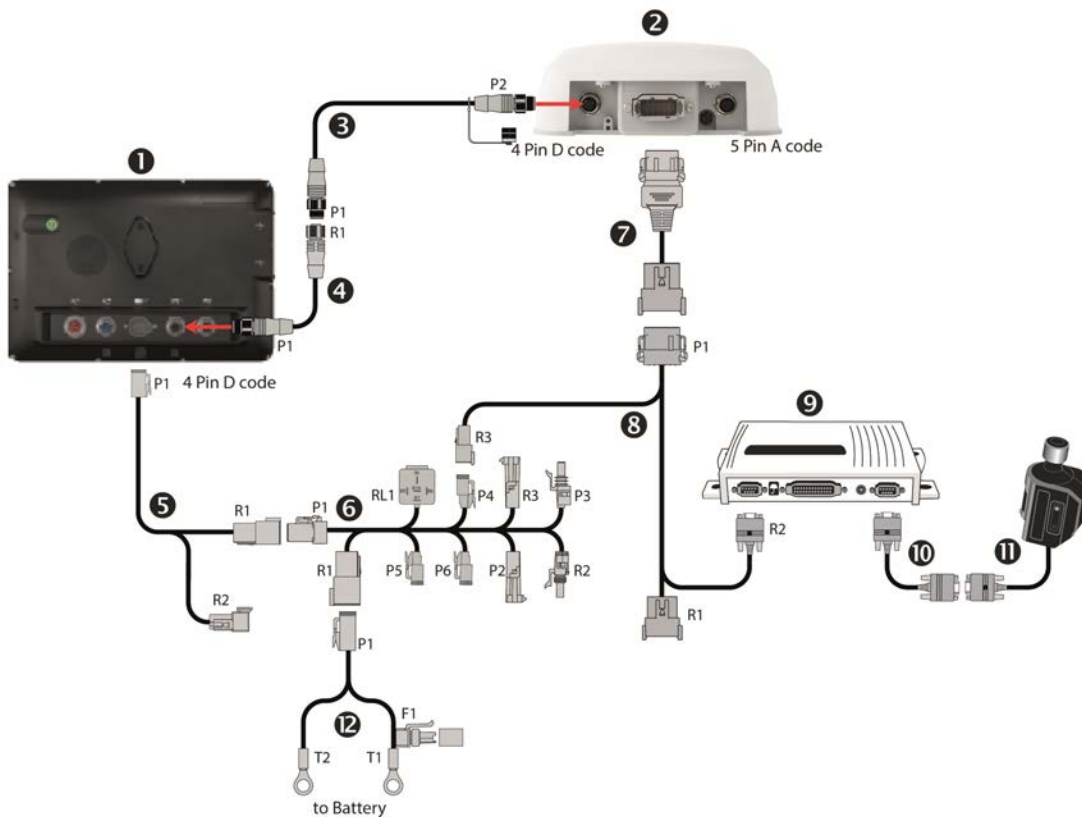

Item	Description	P/N
1	GFX/XCN series displays with PIQ app	
2	NAV-500 or NAV-900 guidance controller	
3	Cable Assy, GFX/XCN to NAV-500/900, Power/Ethernet (BRR), 5 m	110540
4	Cable Assy, GFX/XCN to NAV-500/900, Power/Ethernet (BRR) Extension, 2.5 m	112082
5	Cable Assy, GFX/XCN, Power to display, CAN, 2.5 m	110551
6	Cable Assy, GFX/CFX/FM-750/XCN/FMX/FM-1000 Power with Relay and Switch (Acc)	67259
7	Cable Assy, NAV-500/900 to EZ-Steer	111329
8	Cable Assy, FmX/FM-1000 Display to EZ-Steer w/2 PIN Power Input	75742
9	EZ-Steer® T2 controller	
10	EZ-Steer motor cable	62257
11	EZ-Steer motor	
12	Cable Assy, GFX/CFX/FM-750/XCN/FMX/FM-1000 Basic power, 4 m	67258

2.3 EZ-Pilot Pro with SAM-300 and NAV-500 guidance controller

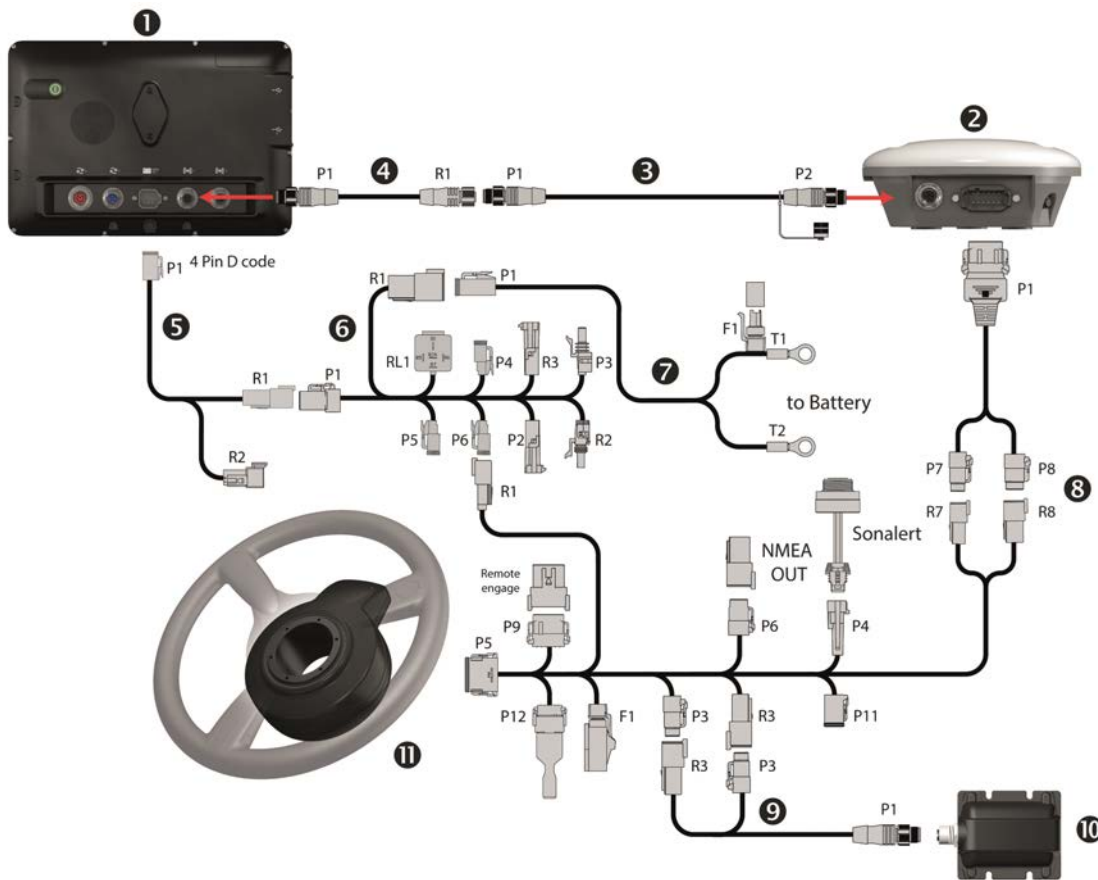

Item	Description	P/N
1	GFX/XCN series displays with PIQ app	
2	NAV-500 guidance controller	
3	Cable Assy, GFX/XCN to NAV-500/900, Power/Ethernet (BRR), 5 m	110540
4	Cable Assy, GFX/XCN to NAV-500/900, Power/Ethernet (BRR) Extension, 2.5 m	112082
5	Cable Assy, GFX/XCN, Power to display, CAN, 2.5 m	110551
6	Cable Assy, GFX/CFX/FM-750/XCN/FMX/FM-1000 Power with Relay and Switch (Acc)	67259
7	Cable Assy, GFX/CFX/FM-750/XCN/FMX/FM-1000 Basic power, 4 m	67258
8	Cable Assy, NAV, IMD, Roof Mount	121096
9	Cable Assy, CAN Extension, IMD-900	112759
10	IMD-900	
11	SAM-300 Motor Drive	

2.4 EZ-Pilot Pro and Autopilot Motor Drive with SAM-300 and NAV-900 guidance controller

Standard cabling

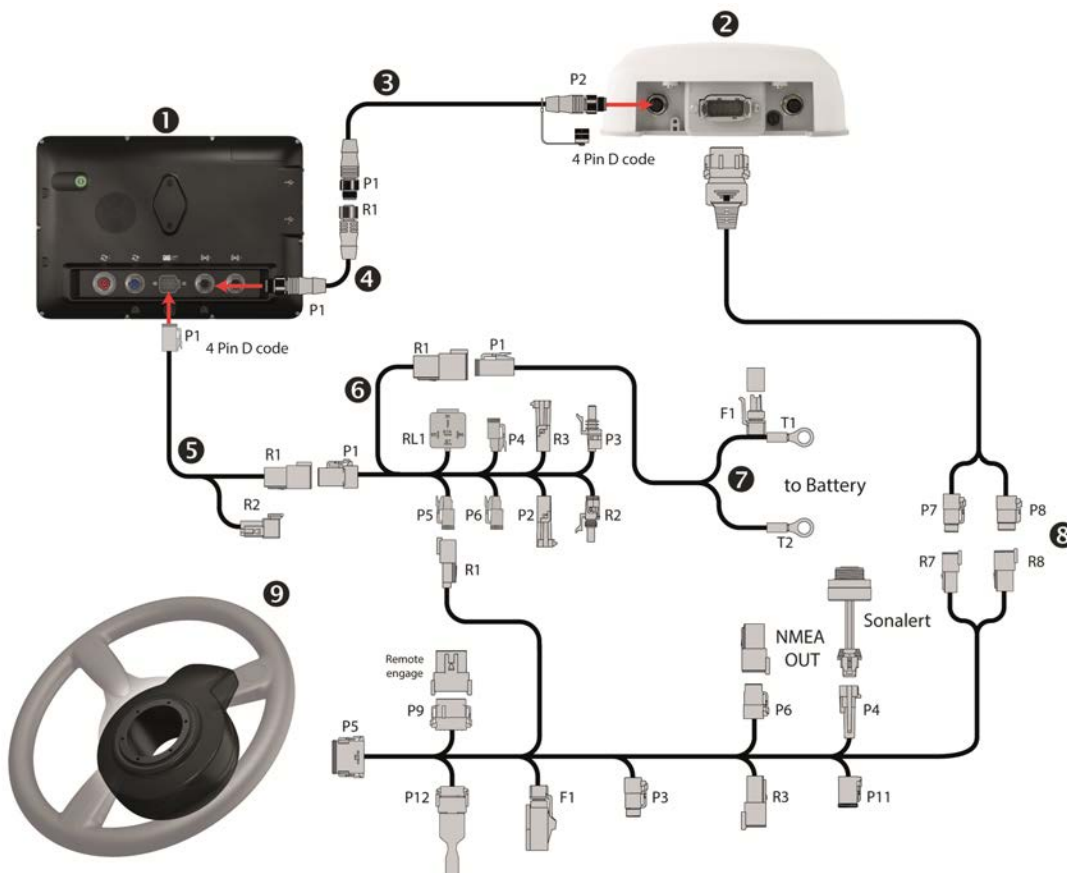

Item	Description	P/N
1	GFX/XCN series displays with PIQ app	
2	NAV-900 Guidance controller only	
3	Cable Assy, GFX/XCN to NAV-500/900, Power/Ethernet (BRR), 5 m	110540
4	Cable Assy, GFX/XCN to NAV-500/900, Power/Ethernet (BRR) Extension, 2.5 m	112082
5	Cable Assy, GFX/XCN, Power to display, CAN, 2.5 m	110551
6	Cable Assy, GFX/CFX/FM-750/XCN/FMX/FM-1000 Power with Relay and Switch (Acc)	67259
7	Cable Assy, GFX/CFX/FM-750/XCN/FMX/FM-1000 Basic power, 4 m	67258

Item	Description	P/N
8	Cable Assy, Electric Motor Drive, SAM-300 (2 sections)	119774
9	SAM-300, Motor Drive	

SAM-300 adapter cable for SAM-200 wiring harness

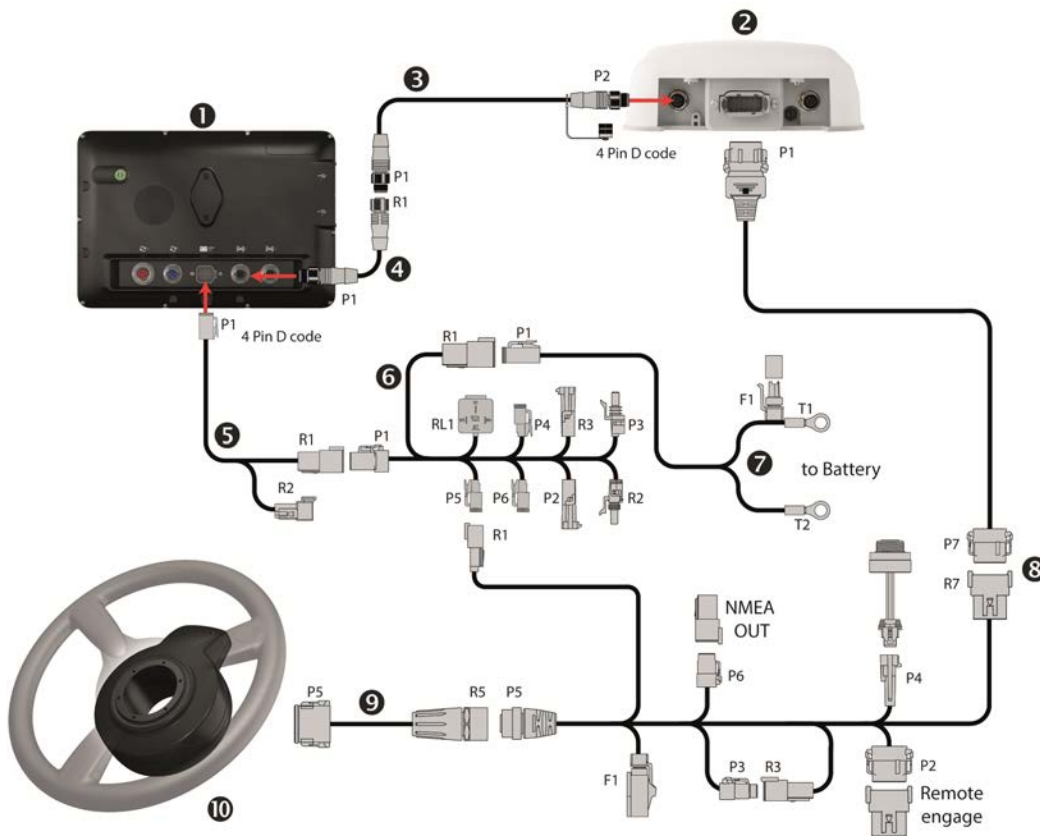

Item	Description	P/N
1	GFX/XCN series displays with PIQ app	
2	NAV-900 Guidance controller only	
3	Cable Assy, GFX/XCN to NAV-500/900, Power/Ethernet (BRR), 5 m	110540
4	Cable Assy, GFX/XCN to NAV-500/900, Power/Ethernet (BRR) Extension, 2.5 m	112082
5	Cable Assy, GFX/XCN, Power to display, CAN, 2.5 m	110551
6	Cable Assy, GFX/CFX/FM-750/XCN/FMX/FM-1000 Power with Relay and Switch (Acc)	67259
7	Cable Assy, GFX/CFX/FM-750/XCN/FMX/FM-1000 Basic power, 4 m	67258
8	Cable Assy, NAV-900 to SAM-200, Motor drive (2 sections)	110549
9	Cable Assy, Adapter, SAM-200 to SAM-300	119775
10	SAM-300, Motor Drive	

SAM-200 adapter cable using SAM-300 wiring harness

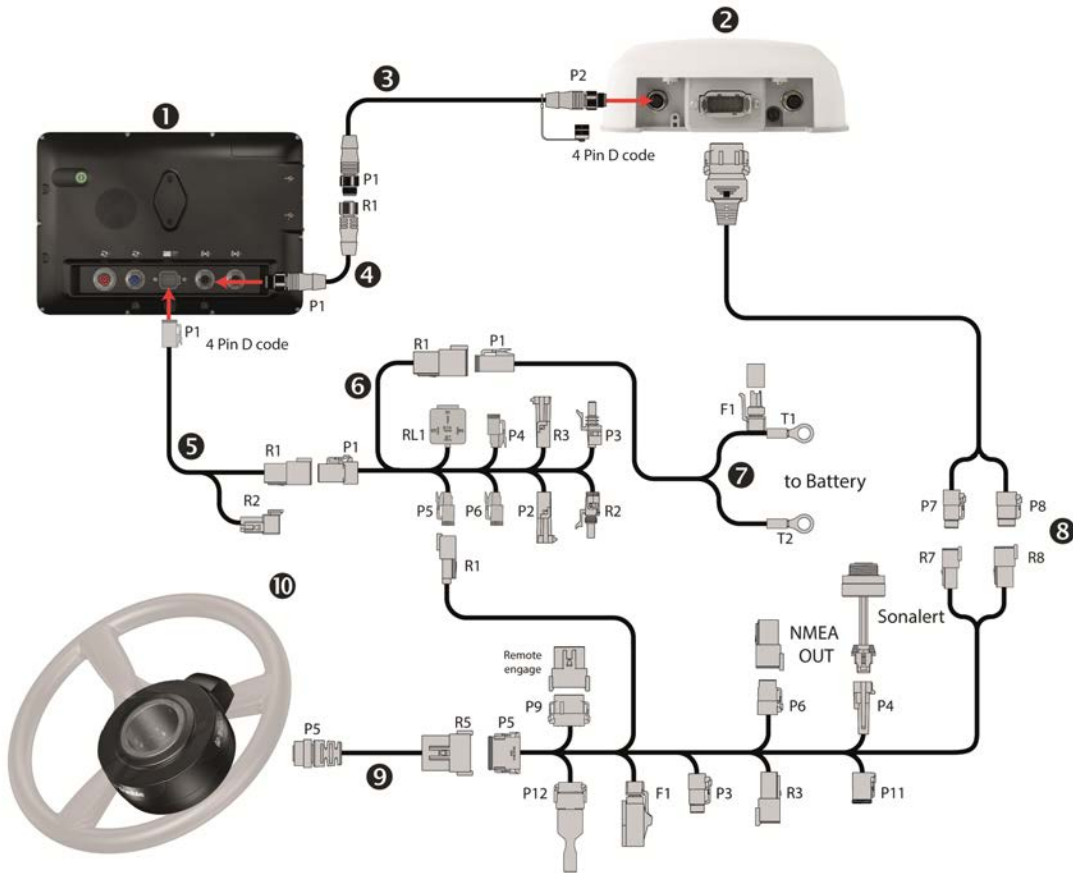

Item	Description	P/N
1	GFX/XCN series displays with PIQ app	
2	NAV-900 Guidance controller only	
3	Cable Assy, GFX/XCN to NAV-500/900, Power/Ethernet (BRR), 5 m	110540
4	Cable Assy, GFX/XCN to NAV-500/900, Power/Ethernet (BRR) Extension, 2.5 m	112082
5	Cable Assy, GFX/XCN, Power to display, CAN, 2.5 m	110551
6	Cable Assy, GFX/CFX/FM-750/XCN/FMX/FM-1000 Power with Relay and Switch (Acc)	67259
7	Cable Assy, GFX/CFX/FM-750/XCN/FMX/FM-1000 Basic power, 4 m	67258
8	Cable Assy, Electric Motor Drive, SAM-300 (2 sections)	119774
9	Cable Assy, Adapter, SAM-300 to SAM-200	121739
10	SAM-200, Motor Drive	

2.5 Autopilot CAN Steer (on-roof connection) with NAV-900 guidance controller

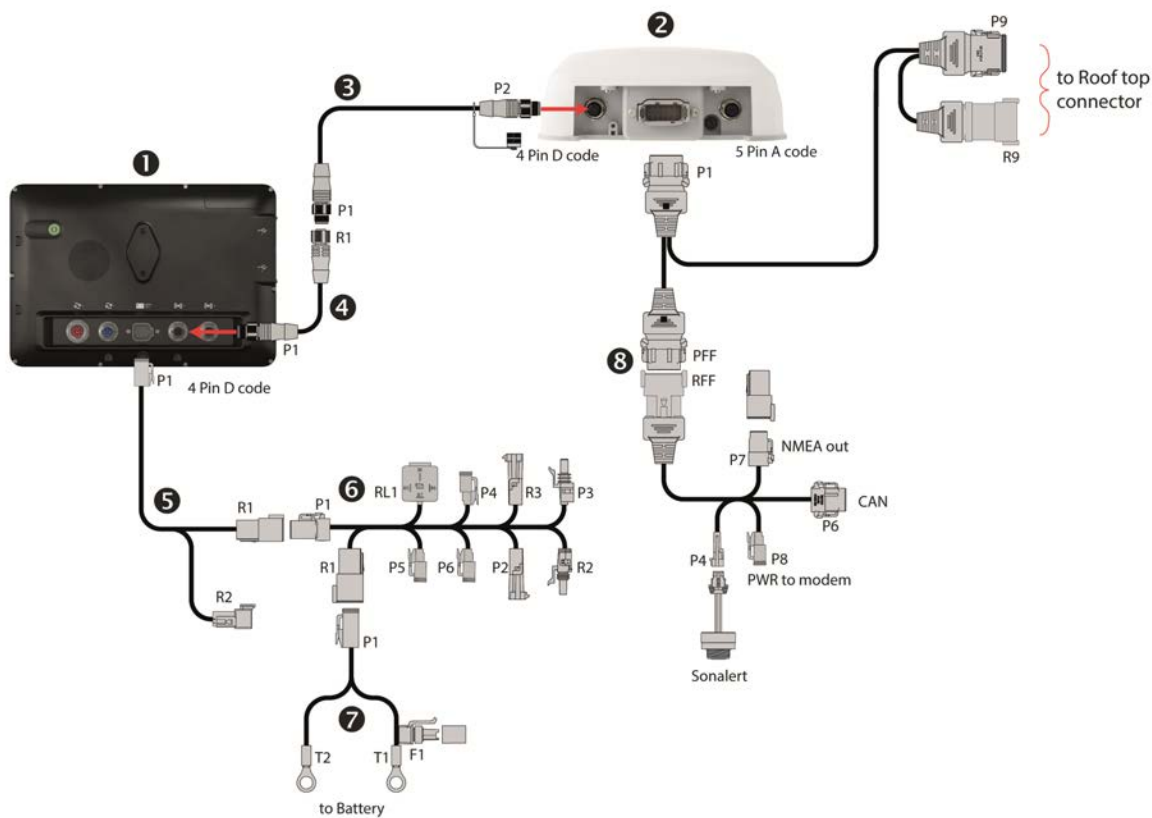

Item	Description	P/N
1	GFX/XCN series displays with PIQ app	
2	NAV-900 guidance controller only	
3	Cable Assy, GFX/XCN to NAV-500/900, Power/Ethernet (BRR), 5 m	110540
4	Cable Assy, GFX/XCN to NAV-500/900, Power/Ethernet (BRR) Extension, 2.5 m	112082
5	Cable Assy, GFX/XCN, Power to display, CAN, 2.5 m	110551
6	Cable Assy, GFX/CFX/FM-750/XCN/FMX/FM-1000 Power with Relay and Switch (Acc)	67259
7	Cable Assy, GFX/CFX/FM-750/XCN/FMX/FM-1000 Basic power, 4 m	67258
8	Cable Assy, NAV-900, CAN - ISO, JD, Roof-Top, Guidance	113699

2.6 Autopilot IMD-900 CAN Steer (on-roof connection) with NAV-900 guidance controller

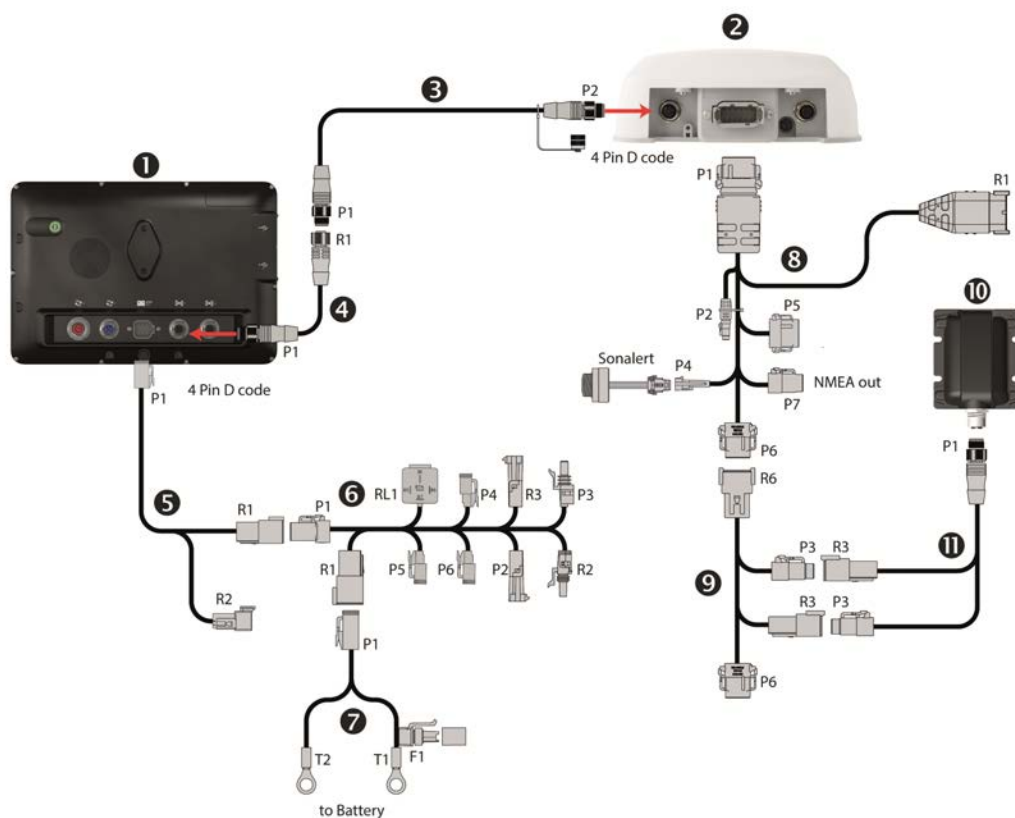

Item	Description	P/N
1	GFX/XCN series displays with PIQ app	
2	NAV-900 guidance controller only	
3	Cable Assy, GFX/XCN to NAV-500/900, Power/Ethernet (BRR), 5 m	110540
4	Cable Assy, GFX/XCN to NAV-500/900, Power/Ethernet (BRR) Extension, 2.5 m	112082
5	Cable Assy, GFX/XCN, Power to display, CAN, 2.5 m	110551
6	Cable Assy, GFX/CFX/FM-750/XCN/FMX/FM-1000 Power with Relay and Switch (Acc)	67259
7	Cable Assy, GFX/CFX/FM-750/XCN/FMX/FM-1000 Basic power, 4 m	67258
8	Cable Assy, NAV-900, CAN - ISO, JD, Roof-Top, Guidance	122387
9	Cable Assy, NAV-900 CAN Guidance, IMD-900, Adapter	113261
10	IMD-900	
11	Cable Assy, CAN Extension, IMD-900	112759

2.7 Autopilot (using NavController II/III) as an external guidance device with IMD-900 and NAV-900 guidance controller

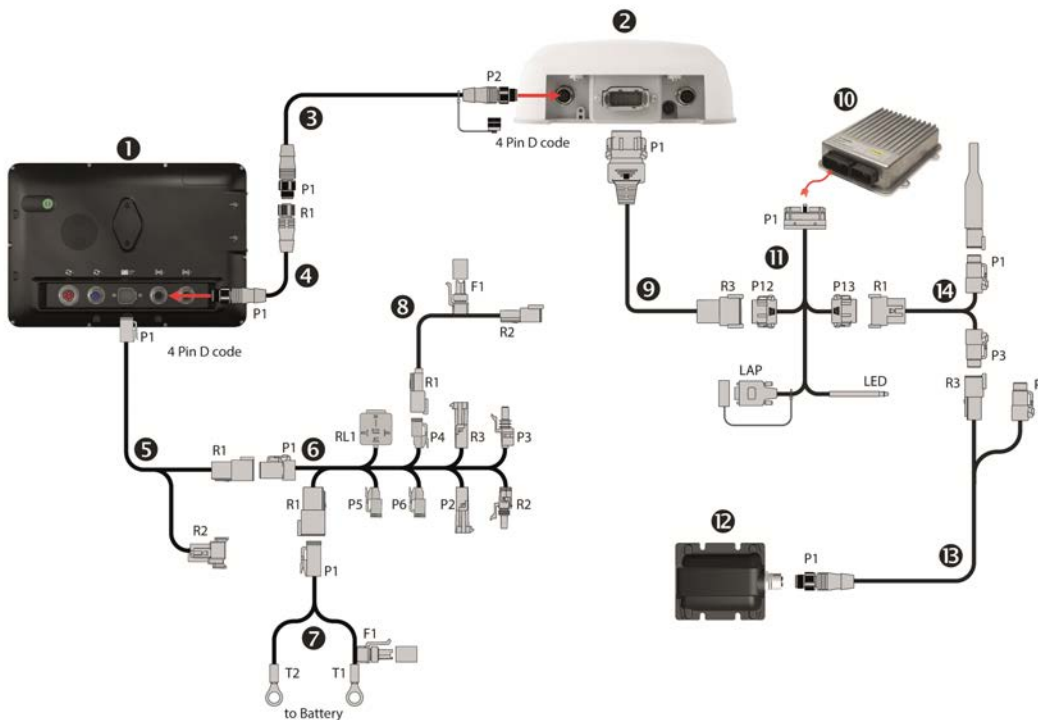

Item	Description	P/N
1	GFX/XCN series displays with PIQ app	
2	NAV-900 guidance controller only	
3	Cable Assy, GFX/XCN to NAV-500/900, Power/Ethernet (BRR), 5 m	110540
4	Cable Assy, GFX/XCN to NAV-500/900, Power/Ethernet (BRR) Extension, 2.5 m. Optional extension for large vehicles.	112082
5	Cable Assy, GFX/XCN, Power to display, CAN, 2.5 m	110551
6	Cable Assy, GFX/CFX/FM-750/XCN/FMX/FM-1000 Power with Relay and Switch (Acc)	67259
7	Cable Assy, GFX/CFX/FM-750/XCN/FMX/FM-1000 Basic power, 4 m	67258
8	Cable Assy, 2 PIN DTM to 2 PIN DT Power adapter	67095
9	Cable Assy, NAV-500/900 to Nav II/III, Autopilot	110547
10	NavController II/III	
11	Cable Assy, Diagnostic, NAVII	54602
12	IMD-900	
13	Cable Assy, CAN Extension, IMD-900	112759

Item	Description	P/N
14	Cable Assy, NAV III to IMD-900	114675

2.8 Autopilot (using NavController II/III) as an external guidance device with NAV-900 guidance controller

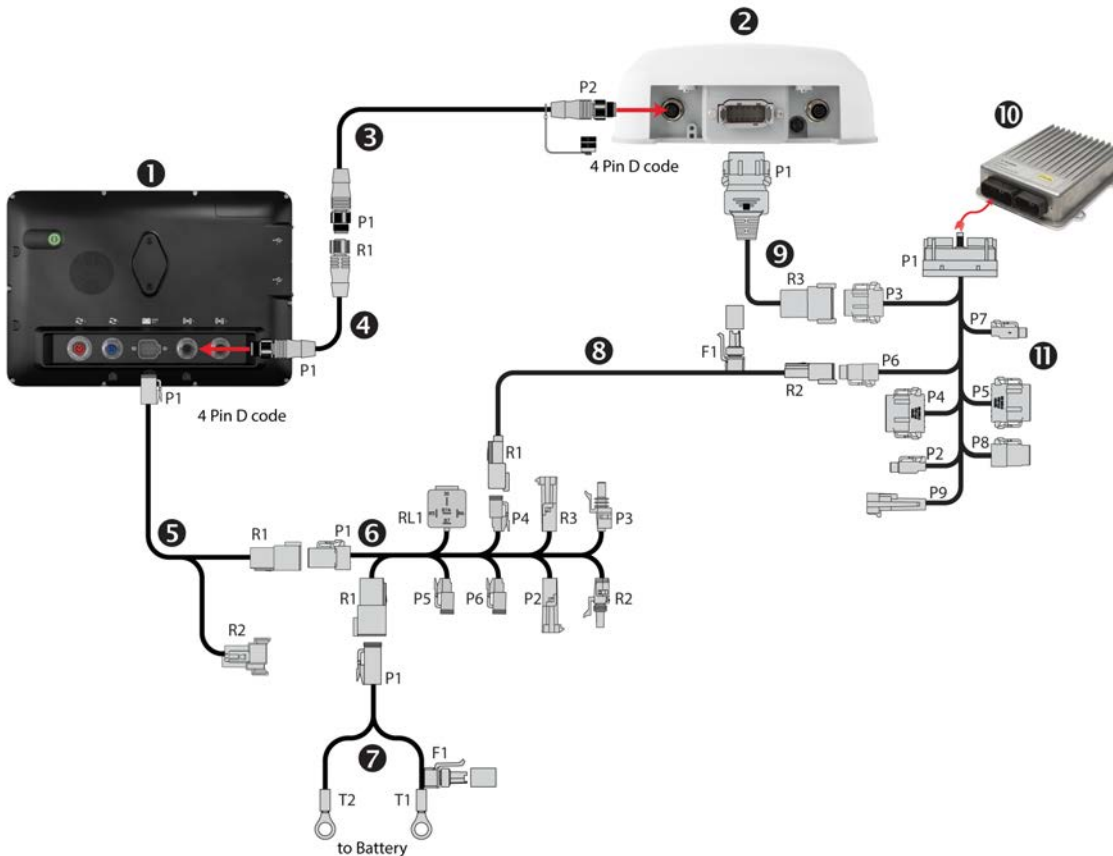

Item	Description	P/N
1	GFX/XCN series displays with PIQ app	
2	NAV-900 guidance controller only	
3	Cable Assy, GFX/XCN to NAV-500/900, Power/Ethernet (BRR), 5 m	110540
4	Cable Assy, GFX/XCN to NAV-500/900, Power/Ethernet (BRR) Extension, 2.5 m. Optional extension for large vehicles.	112082
5	Cable Assy, GFX/XCN, Power to display, CAN, 2.5 m	110551
6	Cable Assy, GFX/CFX/FM-750/XCN/FMX/FM-1000 Power with Relay and Switch (Acc)	67259
7	Cable Assy, GFX/CFX/FM-750/XCN/FMX/FM-1000 Basic power, 4 m	67258
8	Cable Assy, 2 PIN DTM to 2 PIN DT Power adapter	67095
9	Cable Assy, NAV-500/900 to Nav II/III, Autopilot	110547

Item	Description	P/N
10	NavController II/III	
11	Cable, NavController II/III, Main	54601

2.9 Autopilot CNH, AGR – CAN with NAV-900 guidance controller

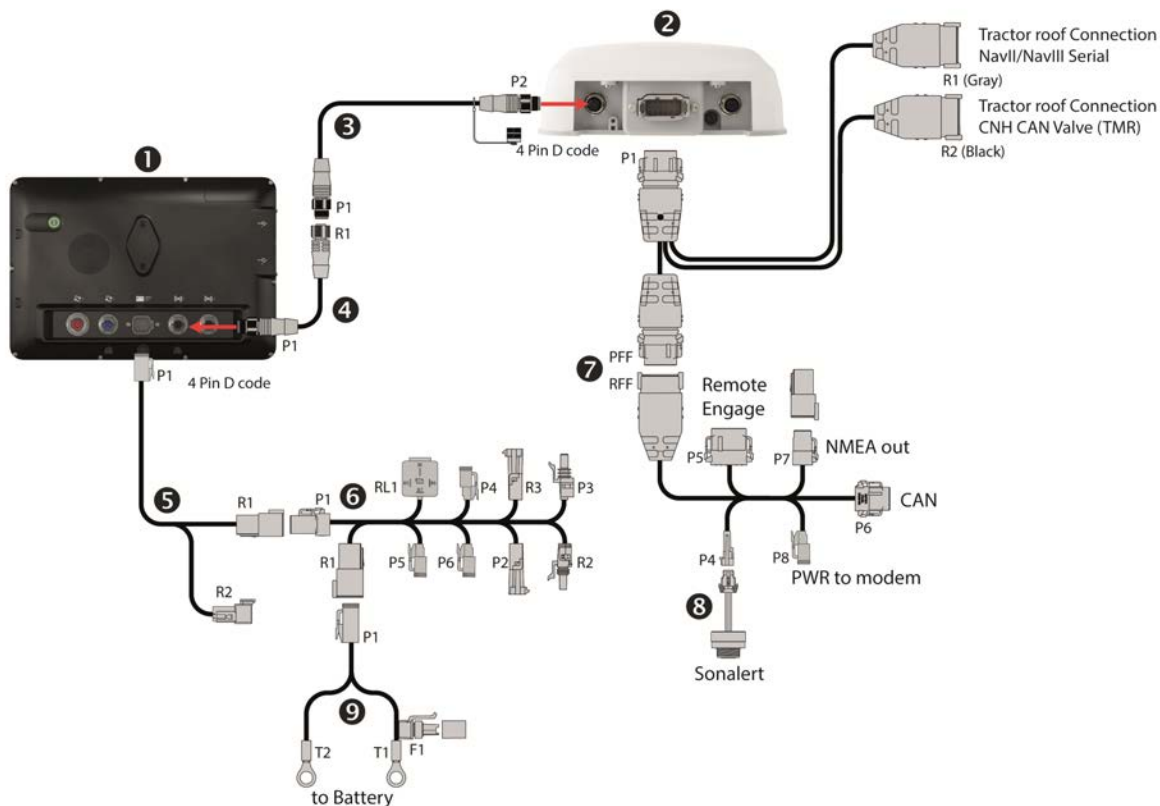

Item	Description	P/N
1	GFX/XCN series displays with PIQ app	
2	NAV-900 guidance controller only	
3	Cable Assy, GFX/XCN to NAV-500/900, Power/Ethernet (BRR), 5 m	110540
4	Cable Assy, GFX/XCN to NAV-500/900, Power/Ethernet (BRR) Extension, 2.5 m. Optional extension for large vehicles.	112082
5	Cable Assy, GFX/XCN, Power to display, CAN, 2.5 m	110551
6	Cable Assy, GFX/CFX/FM-750/XCN/FMX/FM-1000 Power with Relay and Switch (Acc) (optional)	67259
7	Cable Assy, NAV-900, CNH, CAN/AGR Hybrid	114728
8	Sonalert	
9	Cable Assy, GFX/CFX/FM-750/XCN/FMX/FM-1000 Basic power, 4 m	67258

2.10 Autopilot CNH Hybrid with NAV-900 guidance controller

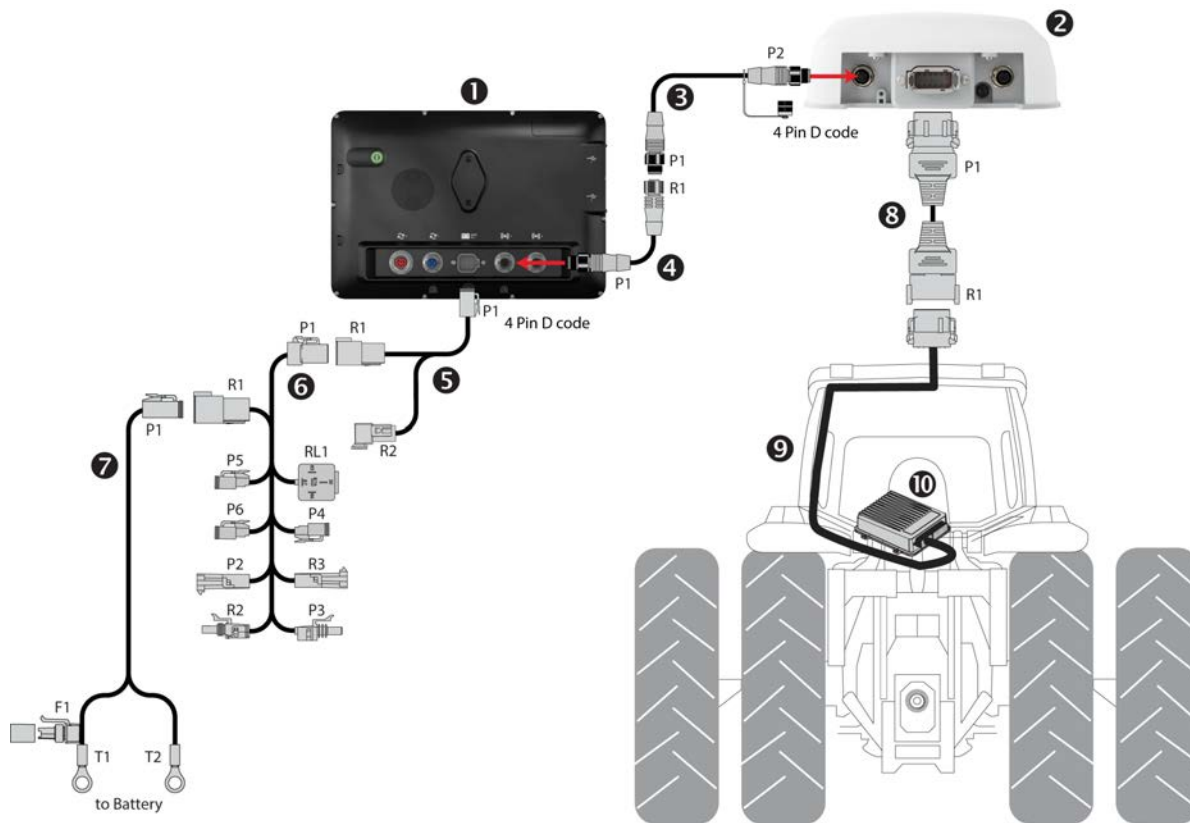

Item	Description	P/N
1	GFX/XCN series displays with PIQ app	
2	NAV-900 guidance controller only	
3	Cable Assy, GFX/XCN to NAV-500/900, Power/Ethernet (BRR), 5 m	110540
4	Cable Assy, GFX/XCN to NAV-500/900, Power/Ethernet (BRR) Extension, 2.5 m. Optional extension for large vehicles.	112082
5	Cable Assy, GFX/XCN, Power to display, CAN, 2.5 m	110551
6	Cable Assy, GFX/CFX/FM-750/XCN/FMX/FM-1000 Power with Relay and Switch (Acc) - optional	67259
7	Cable Assy, GFX/CFX/FM-750/XCN/FMX/FM-1000 Basic power, 4 m	67258
8	Cable Assy, NAV-900, CNH AGR non CAN	114705
9	CNH vehicle factory harness	
10	NavController III	55566-00

2.11 Autopilot using VDM-912 valve driver and NAV-900 guidance controller

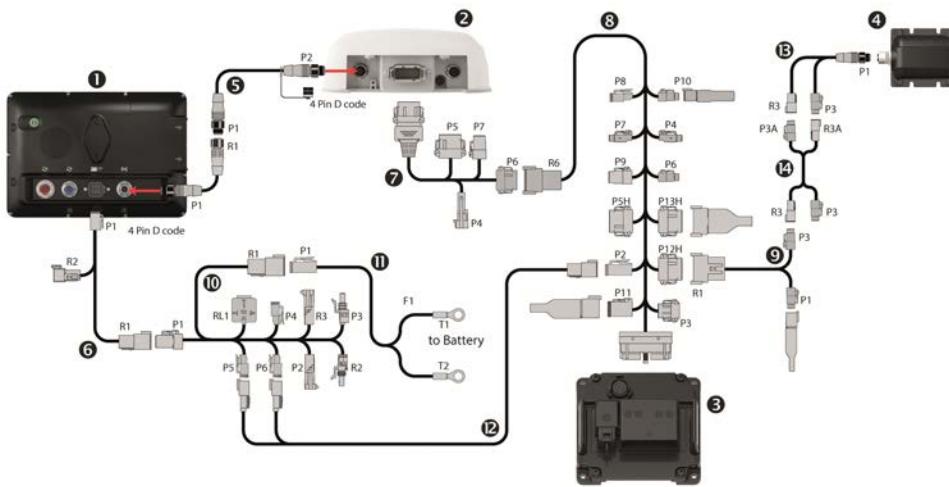

Item	Description	P/N
1	GFX/XCN series displays with PIQ app	
2	NAV-900 guidance controller only	
3	VDM-912 hydraulic valve driver module	
4	IMD-900 Inertial Measurement Unit	
5	Cable Assy, GFX/XCN to NAV-500/900, Power/Ethernet (BRR), 5 m	110540
6	Cable Assy, GFX/XCN, Power to display, CAN, 2.5 m	110551
7	Cable Assy, NAV-900, CAN ISO to cab Guidance, 4 m	110550
8	Cable Assy, VDM-9XX, Main	116982
9	Cable Assy, NAV III to IMD-900	114675
10	Cable Assy, GFX/CFX/FM-750/XCN/FMX/FM-1000 Power with Relay and Switch (Acc)	67259
11	Cable Assy, GFX/CFX/FM-750/XCN/FMX/FM-1000 Basic power, 4 m	67258
12	Cable Assy, VDM-9XX, PWR	116985
13	Cable Assy, CAN Extension, IMD-900	112759
14	Cable Assy, IMD-900 CAN Extention, 10 ft (optional)	116575

2.12 Field-IQ with NAV-500 or NAV-900 guidance controller

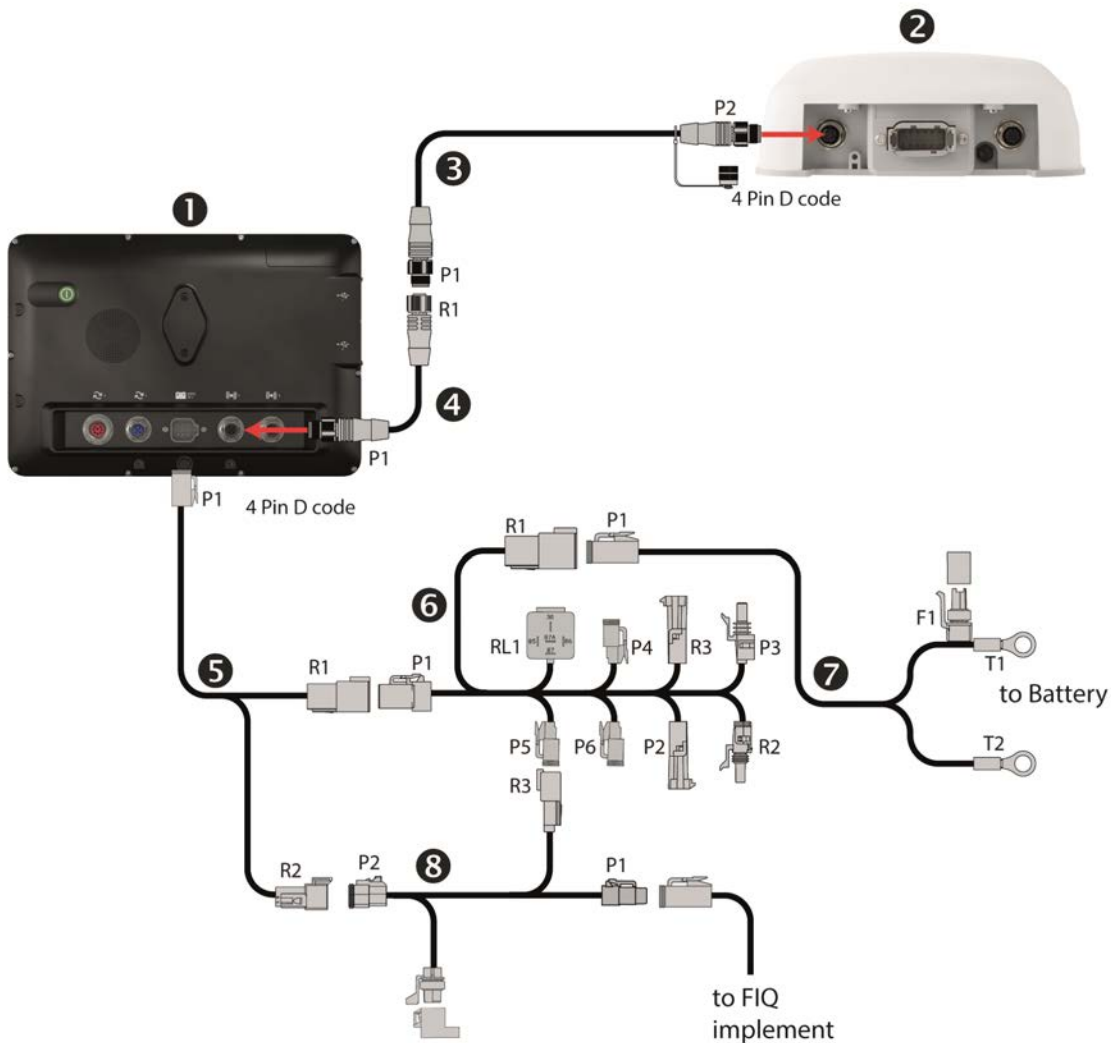

Item	Description	P/N
1	GFX/ XCN series displays with PIQ app	
2	NAV-500 or NAV-900 guidance controller	
3	Cable Assy, GFX/XCN to NAV-500/900, Power/Ethernet (BRR), 5 m	110540
4	Cable Assy, GFX/XCN to NAV-500/900, Power/Ethernet (BRR) Extension, 2.5 m. Optional extension for large vehicles.	112082
5	Cable Assy, GFX/XCN, Power to display, CAN, 2.5 m	110551
6	Cable Assy, GFX/CFX/FM-750/XCN/FMX/FM-1000 Power with Relay and Switch (Acc)	67259

Item	Description	P/N
7	Cable Assy, GFX/CFX/FM-750/XCN/FMX/FM-1000 Basic Power, 4 m	67258
8	Cable Assy, GFX/XCN, Field IQ, Active CAN terminator	111083

2.13 Field-IQ – Full harness with NAV-500 or NAV-900 guidance controller

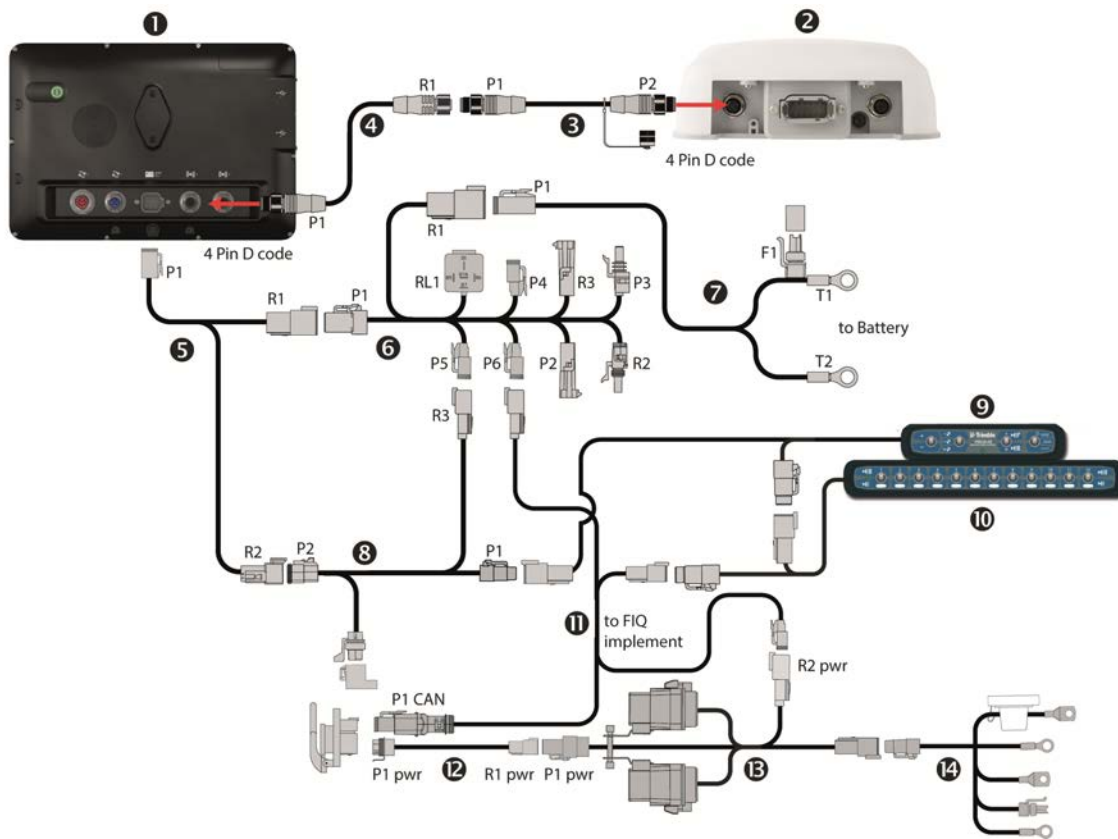

Item	Description	P/N
1	GFX/XCN series displays with PIQ app	
2	NAV-500 or NAV-900 guidance controller	
3	Cable Assy, GFX/XCN to NAV-500/900, Power/Ethernet (BRR), 5 m	110540
4	Cable Assy, GFX/XCN to NAV-500/900, Power/Ethernet (BRR) Extension, 2.5 m. Optional extension for large vehicles.	112082
5	Cable Assy, GFX/XCN, Power to display, CAN, 2.5 m	110551
6	Cable Assy, GFX/CFX/FM-750/XCN/FMX/FM-1000 Power with Relay and Switch (Acc)	67259
7	Cable Assy, GFX/CFX/FM-750/XCN/FMX/FM-1000 Basic Power, 4 m	67258
8	Cable Assy, GFX/XCN, Field IQ, Active CAN terminator	111083
9	Field-IQ Master switch box	75050-01
10	Optional: 12 section switch box	75060-01
11	Cable Assy, Field IQ, CAN CAB to Hitch	77368
12	Cable Assy, Powell Quick Disconnect - Tractor Side	77413

Item	Description	P/N
13	Cable Assy, Dual Relay Pwr Cutoff, Field IQ	77533
14	Cable Assy, PWR To Cab, Field IQ	76941

2.14 GFX display – Basic set up (ISOBUS terminal)

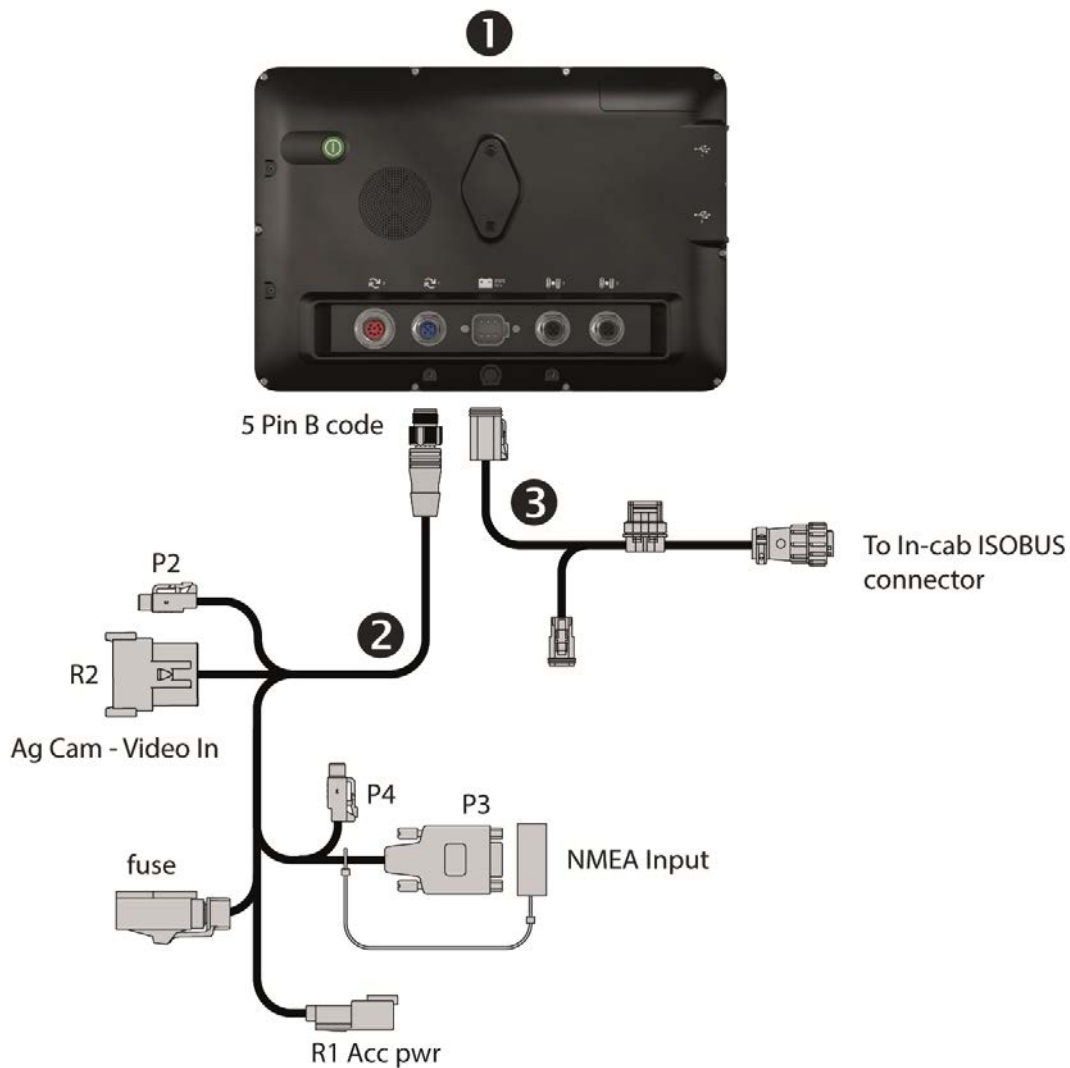

Item	Description	P/N
1	GFX series displays NOTE – NMEA Position Input is supported on the Medium and High Precision-IQ display level only	
2	Cable Assy, GFX/XCN, Expansion Port I , Dig I/O, RS232, Analog AgCam, 2.5 m	114078
3	Cable Assy, Display Power, 9-pin in-cab ISO	122448

2.15 GFX display with ISOBUS Universal Terminal only

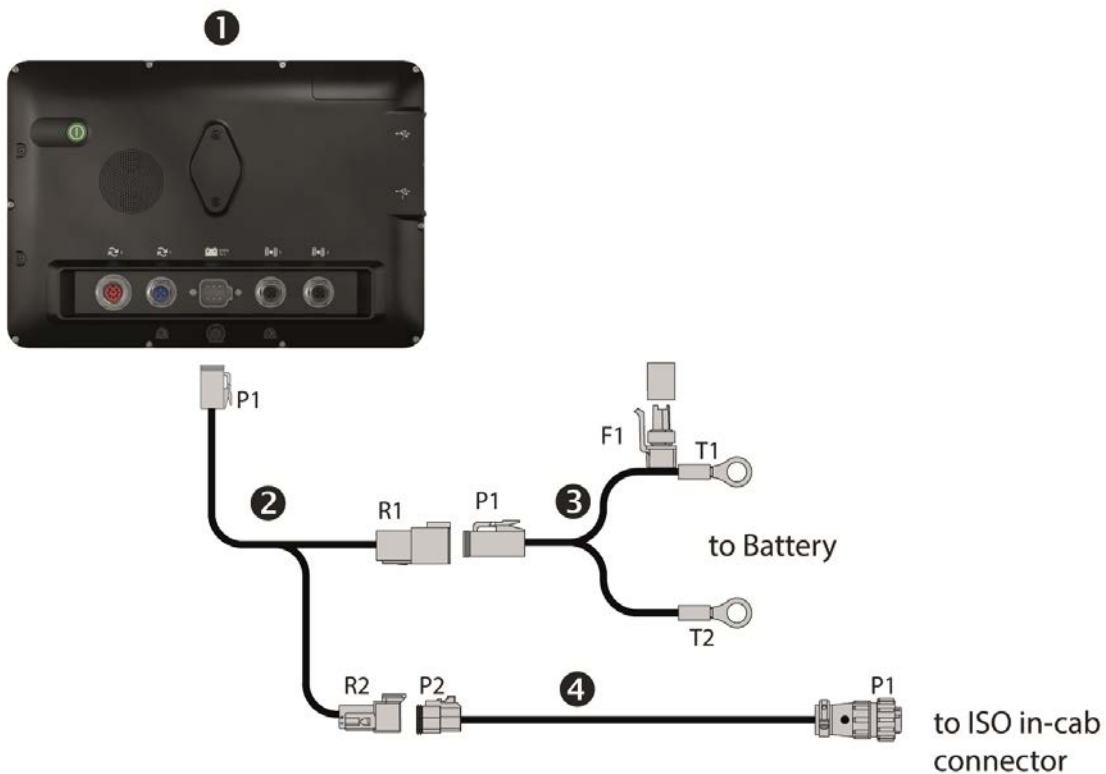

Item	Description	P/N
1	GFX series displays, with Universal Terminal (UT) app (only)	
2	Cable Assy, GFX/XCN, Power to display, CAN, 2.5 m	110551
3	Cable Assy, GFX/CFX/FM-750/XCN/FMX/FM-1000 Basic Power, 4 m	67258
4	Cable Assy, GFX/XCN, ISO connector, CAN, power, 2.5 m	110553

2.16 ISOBUS Universal Terminal – In-cab connector with NAV-500 or NAV-900 guidance controller

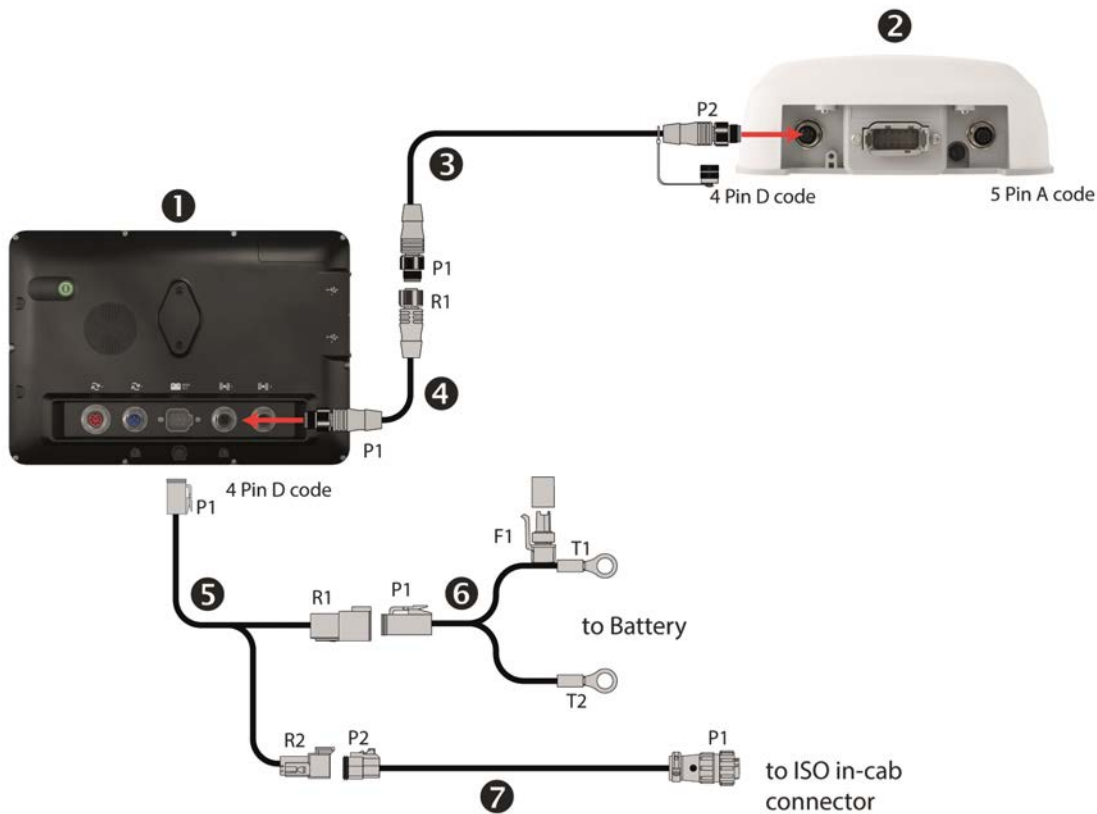

Item	Description	P/N
1	GFX/XCN series displays with PIQ app	
2	NAV-500 or NAV-900 guidance controller	
3	Cable Assy, GFX/XCN to NAV-500/900, Power/Ethernet (BRR), 5 m	110540
4	Cable Assy, GFX/XCN to NAV-500/900, Power/Ethernet (BRR) Extension, 2.5 m. Optional extension for large vehicles.	112082
5	Cable Assy, GFX/XCN, Power to display, CAN, 2.5 m	110551
6	Cable Assy, GFX/CFX/FM-750/XCN/FMX/FM-1000 Basic Power, 4 m	67258
7	Cable Assy, GFX/XCN, ISO connector, CAN, power, 2.5 m	110553

2.17 ISOBUS Universal Terminal – In-cab connector with switch boxes with NAV-500 or NAV-900 guidance controller

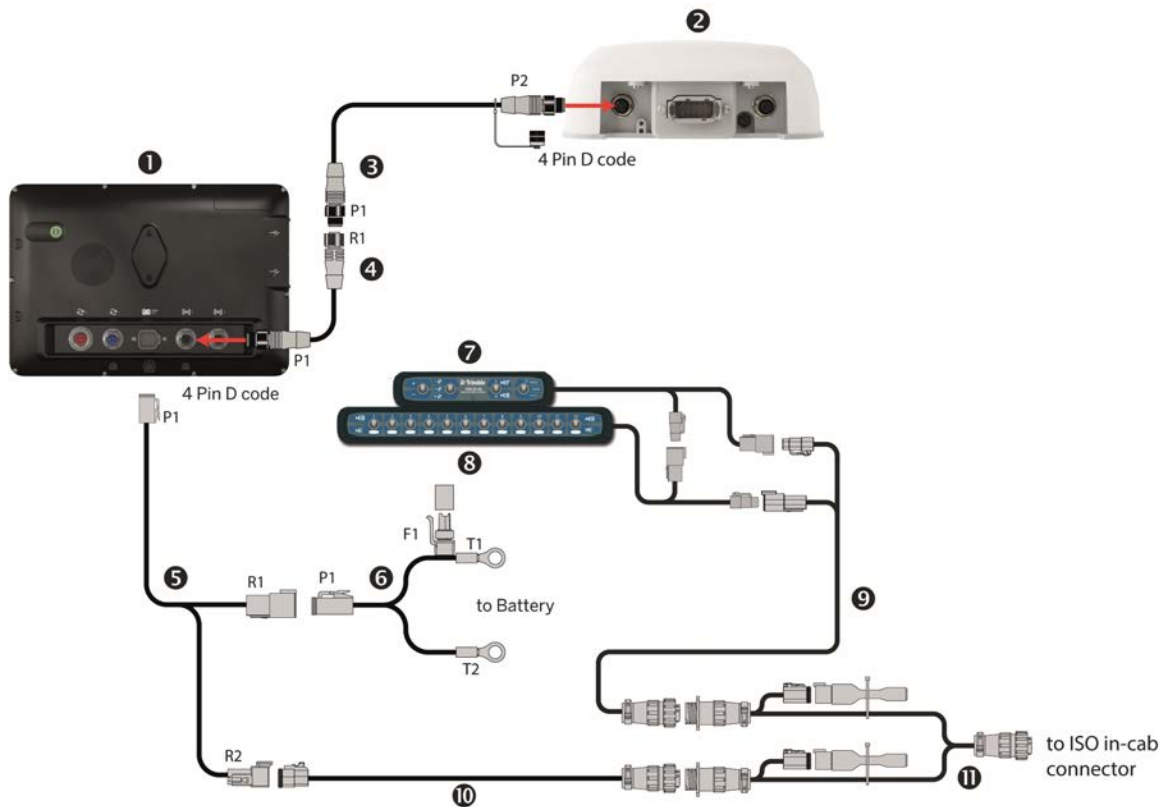

Item	Description	P/N
1	GFX/XCN series displays with PIQ app	
2	NAV-500 or NAV-900 guidance controller	
3	Cable Assy, GFX/XCN to NAV-500/900, Power/Ethernet (BRR), 5 m	110540
4	Cable Assy, GFX/XCN to NAV-500/900, Power/Ethernet (BRR) Extension, 2. 5 m. Optional extension for large vehicles.	112082
5	Cable Assy, GFX/XCN, Power to display, CAN, 2.5 m	110551
6	Cable Assy, GFX/CFX/FM-750/XCN/FMX/FM-1000 Basic Power, 4 m	67258
7	Field-IQ Master switch box	75050-01
8	Optional: 12 section switch box	75060-01
9	Cable Assy, Field-IQ ISO, In-Cab ISO Connector adapter	119627
10	Cable Assy, GFX/XCN, ISO connector, CAN, power, 2.5 m	110553
11	Cable Assy, In-Cab Y Adapter, ISOBUS	97256

2.18 ISOBUS Universal Terminal – Full harness with NAV-500 or NAV-900 guidance controller

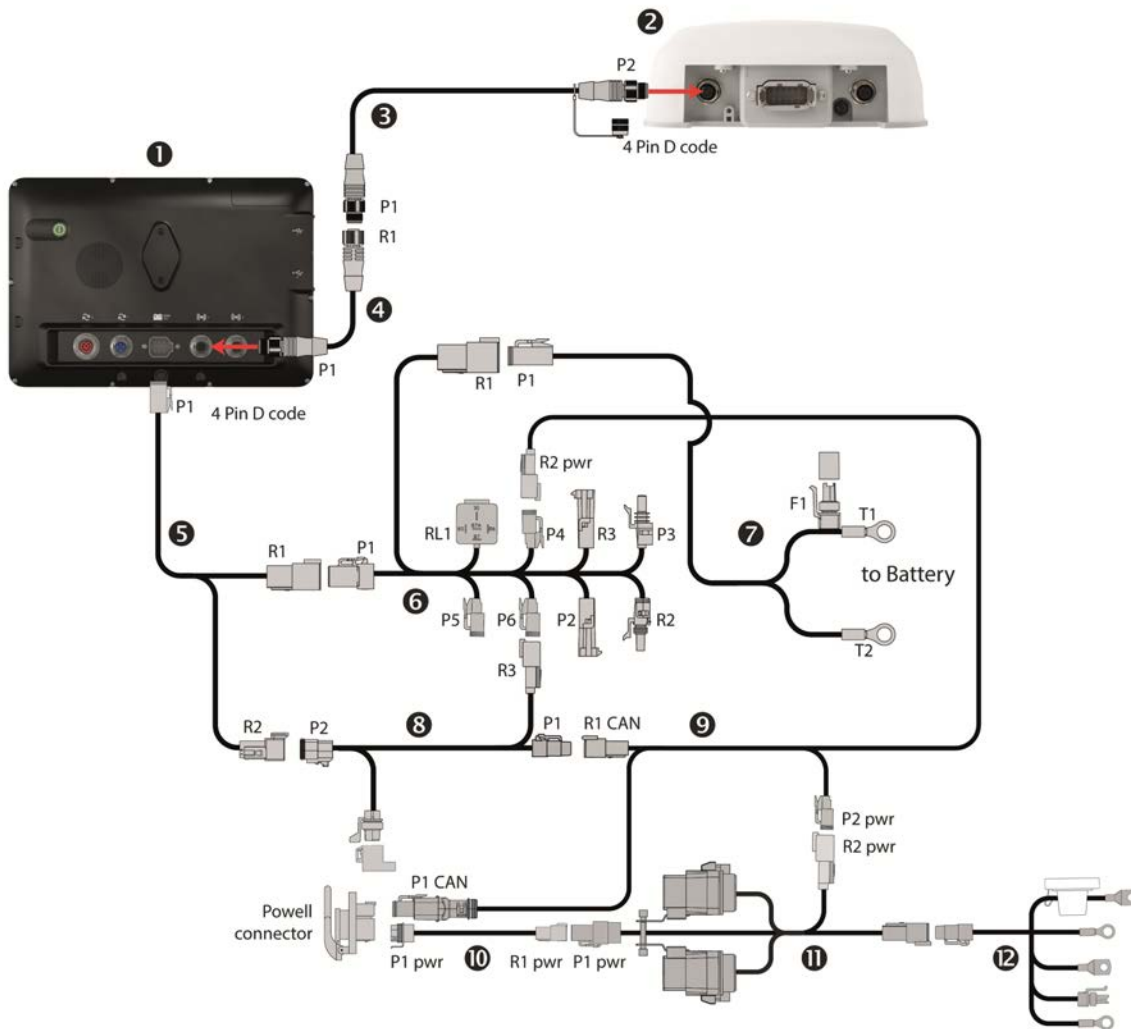

Item	Description	P/N
1	GFX/XCN series displays with PIQ app	
2	NAV-500 or NAV-900 guidance controller	
3	Cable Assy, GFX/XCN to NAV-500/900, Power/Ethernet (BRR), 5 m	110540
4	Cable Assy, GFX/XCN to NAV-500/900, Power/Ethernet (BRR) Extension, 2.5 m. Optional extension for large vehicles.	112082
5	Cable Assy, GFX/XCN, Power to display, CAN, 2.5 m	110551
6	Cable Assy, GFX/CFX/FM-750/XCN/FMX/FM-1000 Power with Relay and Switch (Acc)	67259

Item	Description	P/N
7	Cable Assy, GFX/CFX/FM-750/XCN/FMX/FM-1000 Basic power, 4 m	67258
8	Cable Assy, GFX/XCN, Field IQ, Active CAN terminator	111083
9	Cable Assy, Field IQ, CAN Cab to Hitch	77368
10	Cable Assy, Powell Quick Disconnect - Tractor side	77413
11	Cable Assy, Dual Relay Pwr Cutoff, Field IQ	77533
12	Cable Assy, PWR to cab, Field IQ	76941

2.19 ISOBUS Universal Terminal with switch boxes with NAV-500 or NAV-900 guidance controller

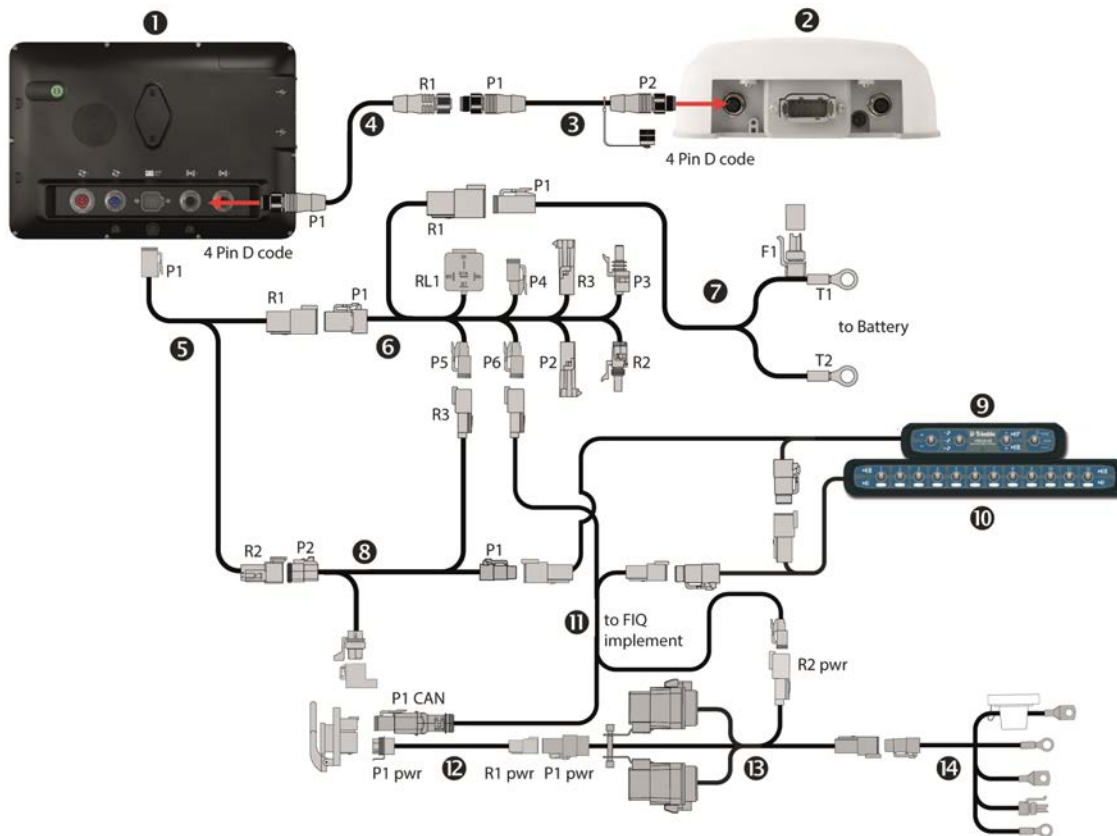

Item	Description	P/N
1	GFX/XCN series displays with PIQ app	
2	NAV-500 or NAV-900 guidance controller	
3	Cable Assy, GFX/XCN to NAV-500/900, Power/Ethernet (BRR), 5 m	110540
4	Cable Assy, GFX/XCN to NAV-500/900, Power/Ethernet (BRR) Extension, 2.5 m. Optional extension for large vehicles.	112082
5	Cable Assy, GFX/XCN, Power to display, CAN, 2.5 m	110551
6	Cable Assy, GFX/CFX/FM-750/XCN/FMX/FM-1000 Power with Relay and Switch (Acc)	67259
7	Cable Assy, GFX/CFX/FM-750/XCN/FMX/FM-1000 Basic power, 4 m	67258
8	Cable Assy, GFX/XCN, Field IQ, Active CAN terminator	111083
9	Field-IQ Master switch box	75050-01
10	Optional: 12 section switch box	75060-01

Item	Description	P/N
11	Cable Assy, Field-IQ, CAN CAB to Hitch	77368
12	Cable Assy, Powell Quick Disconnect - Tractor side	77413
13	Cable Assy, Dual Relay Pwr cutoff, Field-IQ	77533
14	Cable Assy, PWR to cab, Field-IQ	76941

2.20 Expansion port 1 – Multi-use cable for Video In (1), Serial Rate/TUVR, Radar In and Imp Lift (coverage) switch

Use for camera and/or Implement Lift switch and/or radar output and TUVR and serial rate controllers.

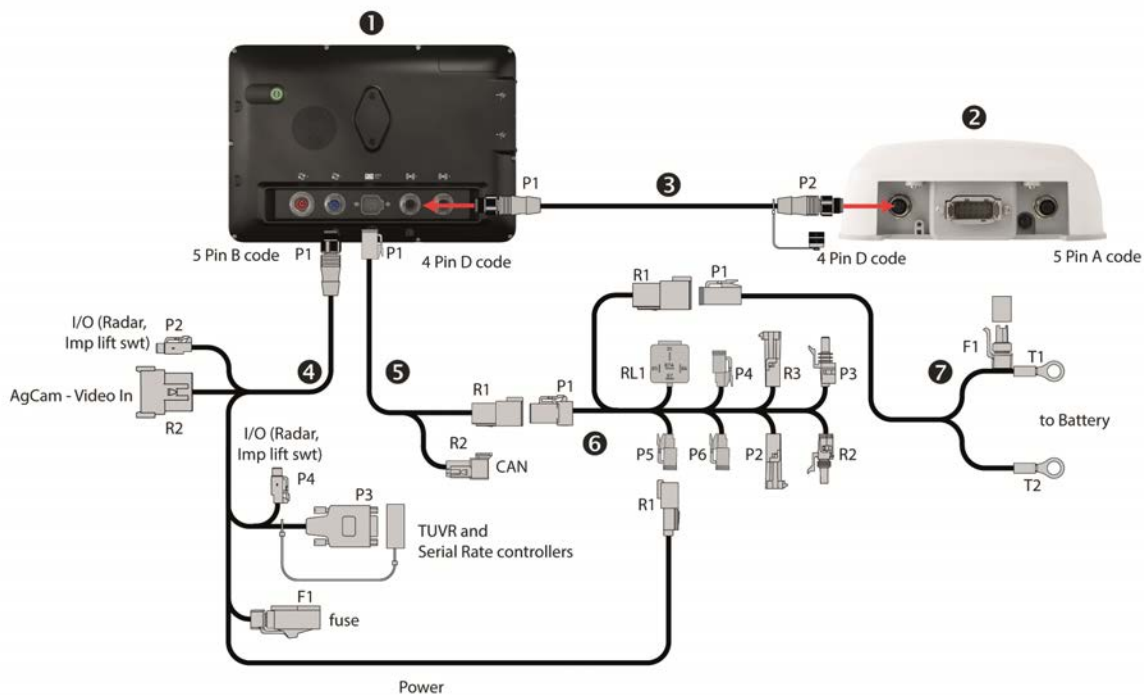

Item	Description	P/N
1	GFX/XCN series displays with PIQ app	
2	NAV-500 or NAV-900 guidance controller	
3	Cable Assy, GFX/XCN to NAV-500/900, Power/Ethernet (BRR), 5 m	110540
4	Cable Assy, GFX/XCN, Expansion Port I , Dig I/O, RS232, Analog AgCam, 2.5 m	114078
5	Cable Assy, GFX/XCN, Power to display, CAN, 2.5 m	110551
6	Cable Assy, GFX/CFX/FM-750/XCN/FMX/FM-1000 Power with Relay and Switch (Acc)	67259
7	Cable Assy, GFX/CFX/FM-750/XCN/FMX/FM-1000 Basic power, 4 m	67258

Radar and serial/TUVR adapters

Controller type	P/N
Raven	69729
Amazone (ISOBUS)	59043
Amazone (AMABUS)	59043
LH-Agro LH5000	59043
Vaderstad	428017
Bogballe	59043
Hardi 5500 and 6500	59043

NOTE – These adapters integrate with the DB9 port on the Expansion port multi-use cable (P/N 114078).

2.21 Expansion port 2 – Cable for Video In only (1)

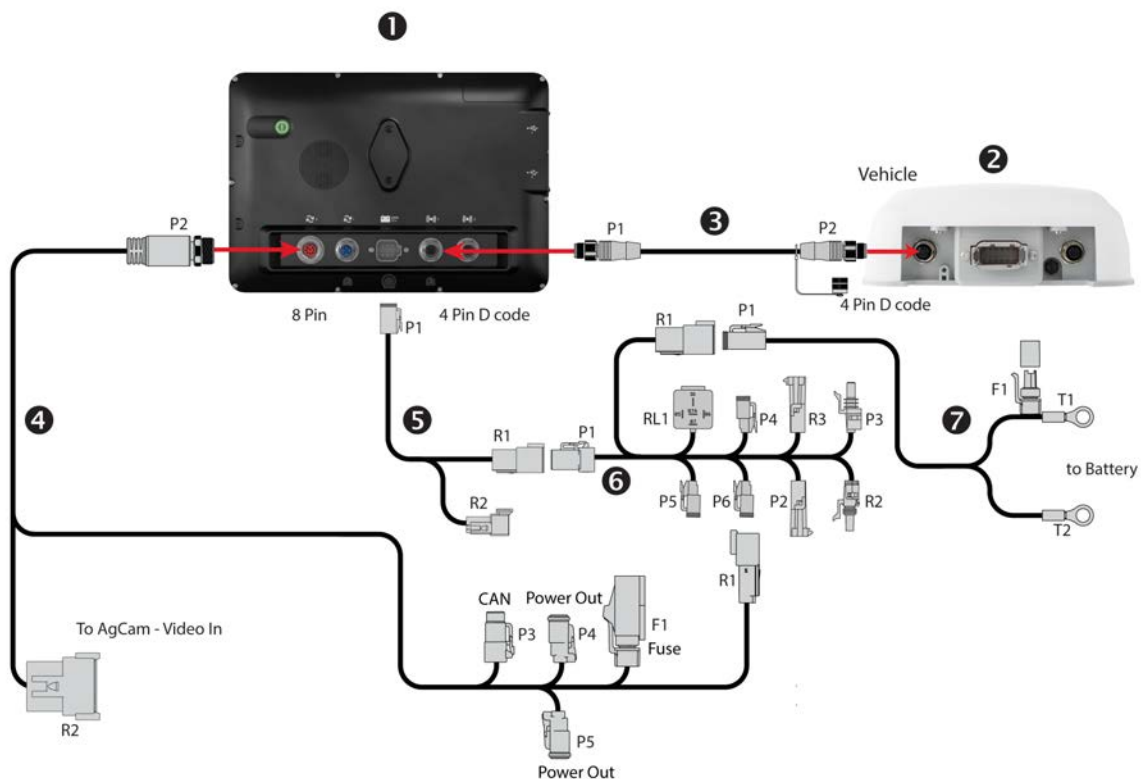

Item	Description	P/N
1	GFX and XCN -1060 and -1260 series displays	
2	NAV-500 or NAV-900 guidance controller	
3	Cable Assy, GFX/XCN to NAV-500/900, Power/Ethernet (BRR), 5 m	110540
4	Cable Assy, GFX/XCN, Base Cable, Expansion Port II , CAN, Dig I/O, Analog AgCam, 2.5 m	121907
5	Cable Assy, GFX/XCN, Power to display, CAN, 2.5 m	110551
6	Cable Assy, GFX/CFX/FM-750/XCN/FMX/FM-1000 Power with Relay and Switch (Acc)	67259
7	Cable Assy, GFX/CFX/FM-750/XCN/FMX/FM-1000 Basic power, 4 m	67258

2.22 Expansion port 2 – Cables for CAN TBC (1) - Field-IQ or ISOBUS

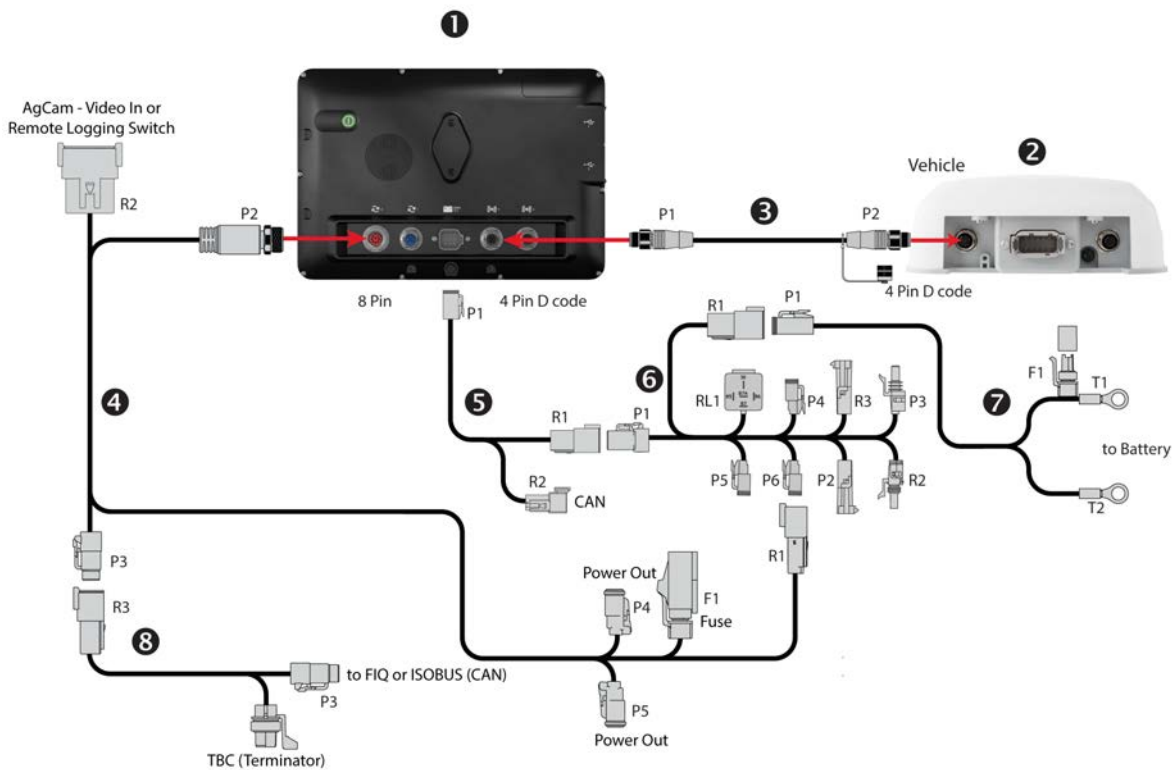

Item	Description	P/N
1	GFX and XCN -1060 and -1260 series displays	
2	NAV-500 or NAV-900 guidance controller	
3	Cable Assy, GFX/XCN to NAV-500/900, Power/Ethernet (BRR), 5 m	110540
4	Cable Assy, GFX/XCN, Base Cable, Expansion Port II , CAN, Dig I/O, Analog AgCam, 2.5 m	121907
5	Cable Assy, GFX/XCN, Power to display, CAN, 2.5 m	110551
6	Cable Assy, GFX/CFX/FM-750/XCN/FMX/FM-1000 Power with Relay and Switch (Acc)	67259
7	Cable Assy, GFX/CFX/FM-750/XCN/FMX/FM-1000 Basic power, 4 m	67258
8	Cable Assy, GFX/XCN, Expansion Port II , CAN Adapter - FIQ, ISOBUS	122462

2.23 Expansion port 1 & 2 – Cables for Video In (2) - Two Cameras

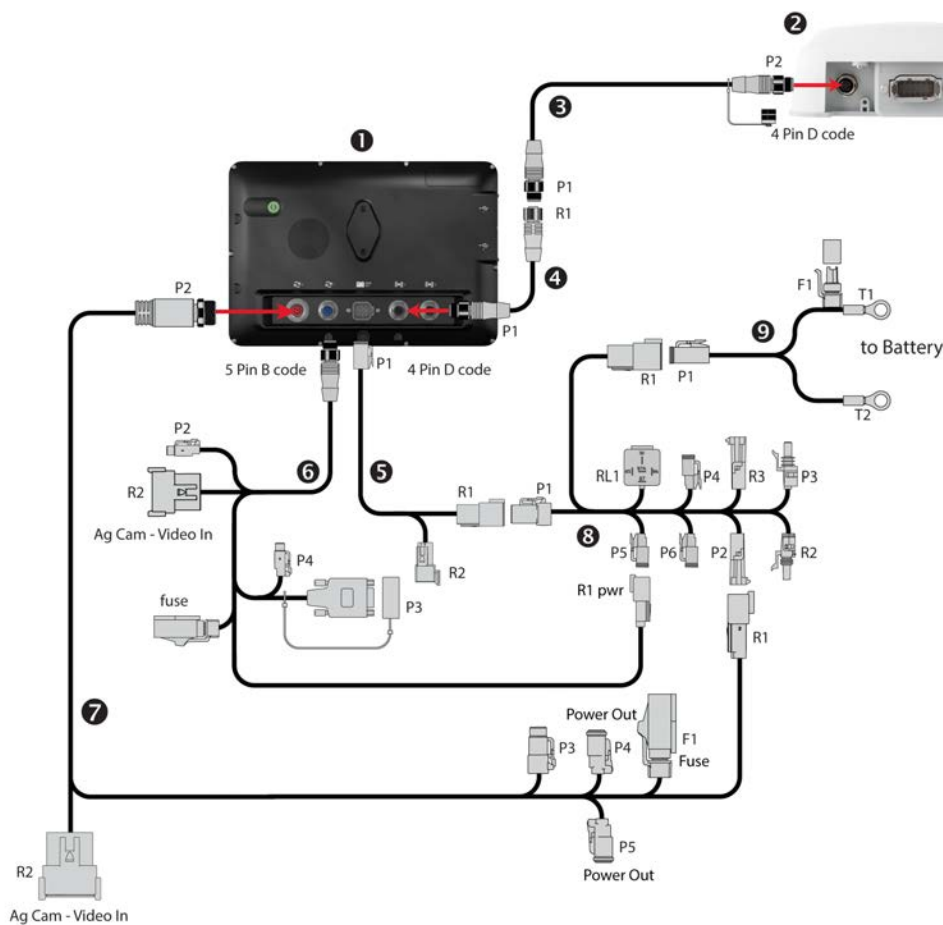

Item	Description	P/N
1	GFX and XCN -1060 and -1260 series displays	
2	NAV-500 or NAV-900 guidance controller	
3	Cable Assy, GFX/XCN to NAV-500/900, Power/Ethernet (BRR), 5 m	110540
4	Cable Assy, GFX/XCN to NAV-500/900, Power/Ethernet (BRR) Extension, 2.5 m. Optional extension for large vehicles.	112082
5	Cable Assy, GFX/XCN, Power to display, CAN, 2.5 m	110551
6	Cable Assy, GFX/XCN, Expansion Port I , Dig I/O, RS232, Analog AgCam, 2.5 m	114078
7	Cable Assy, GFX/XCN, Base Cable, Expansion Port II , CAN, Dig I/O, Analog AgCam, 2.5 m	121907
8	Cable Assy, GFX/CFX/FM-750/XCN/FMX/FM-1000 Power with Relay and Switch (Acc)	67259
9	Cable Assy, GFX/CFX/FM-750/XCN/FMX/FM-1000 Basic power, 4 m	67258

2.24 Expansion port 2 – Cables for Video In (1) plus CAN TBC (1) - Camera plus ISOBUS or Field- IQ

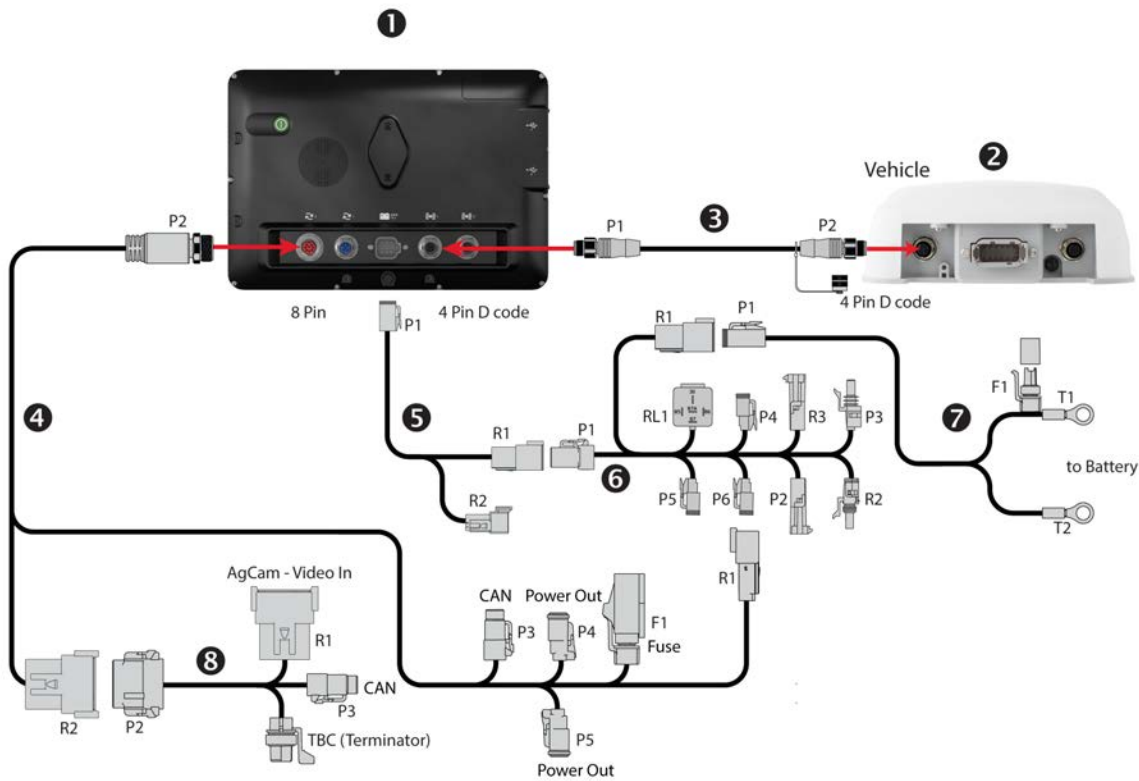

Item	Description	P/N
1	GFX and XCN -1060 and -1260 series displays	
2	NAV-500 or NAV-900 guidance controller	
3	Cable Assy, GFX/XCN to NAV-500/900, Power/Ethernet (BRR), 5 m	110540
4	Cable Assy, GFX/XCN, Base Cable, Expansion Port II , CAN, Dig I/O, Analog AgCam, 2.5 m	121907
5	Cable Assy, GFX/XCN, Power to display, CAN, 2.5 m	110551
6	Cable Assy, GFX/CFX/FM-750/XCN/FMX/FM-1000 Power with Relay and Switch (Acc)	67259
7	Cable Assy, GFX/CFX/FM-750/XCN/FMX/FM-1000 Basic power, 4 m	67258
8	Cable Assy, GFX/XCN, Expansion Port II , CAN/Video Adapter - AgCam,FIQ, ISOBUS	122463

2.25 Expansion port 2 – Cables for FarmStream

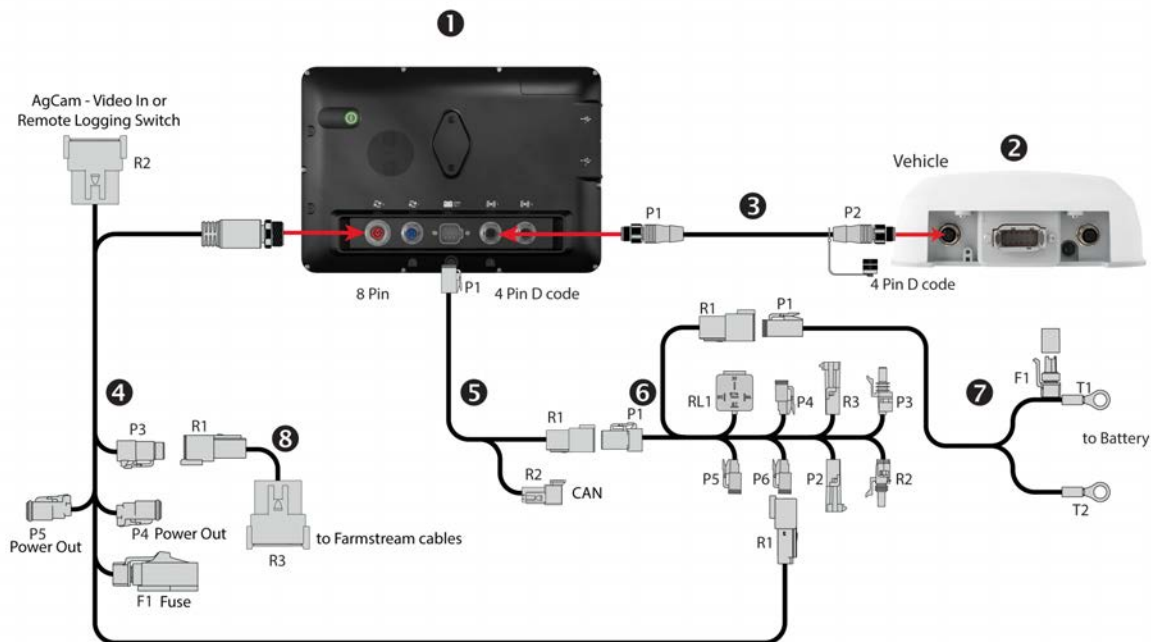

Item	Description	P/N
1	GFX and XCN -1060 and -1260 series displays	
2	NAV-500 or NAV-900 guidance controller	
3	Cable Assy, GFX/XCN to NAV-500/900, Power/Ethernet (BRR), 5 m	110540
4	Cable Assy, GFX/XCN, Base cable, Expansion Port II, CAN, Dig I/O, Analog AgCam, 2.5 m	121907
5	Cable Assy, GFX/XCN, Power to display, CAN, 2.5 m	110551
6	Cable Assy, GFX/CFX/FM-750/XCN/FMX/FM-1000 Power with Relay and Switch (Acc)	67259
7	Cable Assy, GFX/CFX/FM-750/XCN/FMX/FM-1000 Basic power, 4 m	67258
8	Cable Assy, GFX/XCN, Expansion Port II, CAN Adapter - FarmStream	122461

NOTE – Refer to *FarmStream Fleet Solution Cabling Guide* for specific FarmStream adapter cables.

2.26 Expansion port 2 – Cables for CAN TBC (1) and FarmStream - ISOBUS Universal Terminal (with switch boxes) plus FarmStream

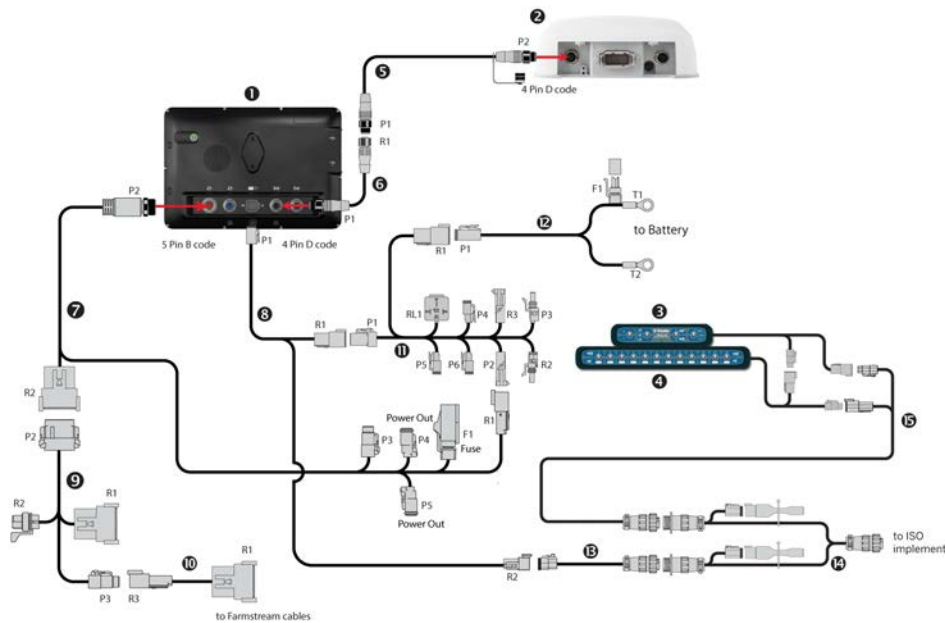

Item	Description	P/N
1	GFX/XCN series displays with PIQ app	
2	NAV-500 or NAV-900 guidance controller	
3	Field-IQ Master switch box	75050-01
4	Optional: 12 section switch box	75060-01
5	Cable Assy, GFX/XCN to NAV-500/900, Power/Ethernet (BRR), 5 m	110540
6	Cable Assy, GFX/XCN to NAV-500/900, Power/Ethernet (BRR) Extension, 2.5 m. Optional extension for large vehicles.	112082
7	Cable Assy, GFX/XCN, Base cable, Expansion Port II, CAN, Dig I/O, Analog AgCam, 2.5 m	121907
8	Cable Assy, GFX/XCN, Power to display, CAN, 2.5 m	110551
9	Cable Assy, GFX/XCN, Expansion Port II , CAN/Video Adapter - AgCam, FIQ, ISOBUS	122463
10	Cable Assy, GFX/XCN, Expansion Port II , CAN Adapter - FarmStream	122461
11	Cable Assy, GFX/CFX/FM-750/XCN/FMX/FM-1000 Power with Relay and Switch (Acc)	67259

Item	Description	P/N
12	Cable Assy, GFX/CFX/FM-750/XCN/FMX/FM-1000 Basic Power, 4 m	67258
13	Cable Assy, GFX/XCN, ISO connector, CAN, power, 2.5 m	110553
14	Cable Assy, In-Cab Y Adapter, ISOBUS	97256
15	Cable Assy, Field-IQ ISO, In-cab ISO connector adapter	119627

NOTE – Refer to *FarmStream Fleet Solution Cabling Guide* for specific FarmStream adapter cables.

2.27 Ag-820 radio with NAV-900 guidance controller

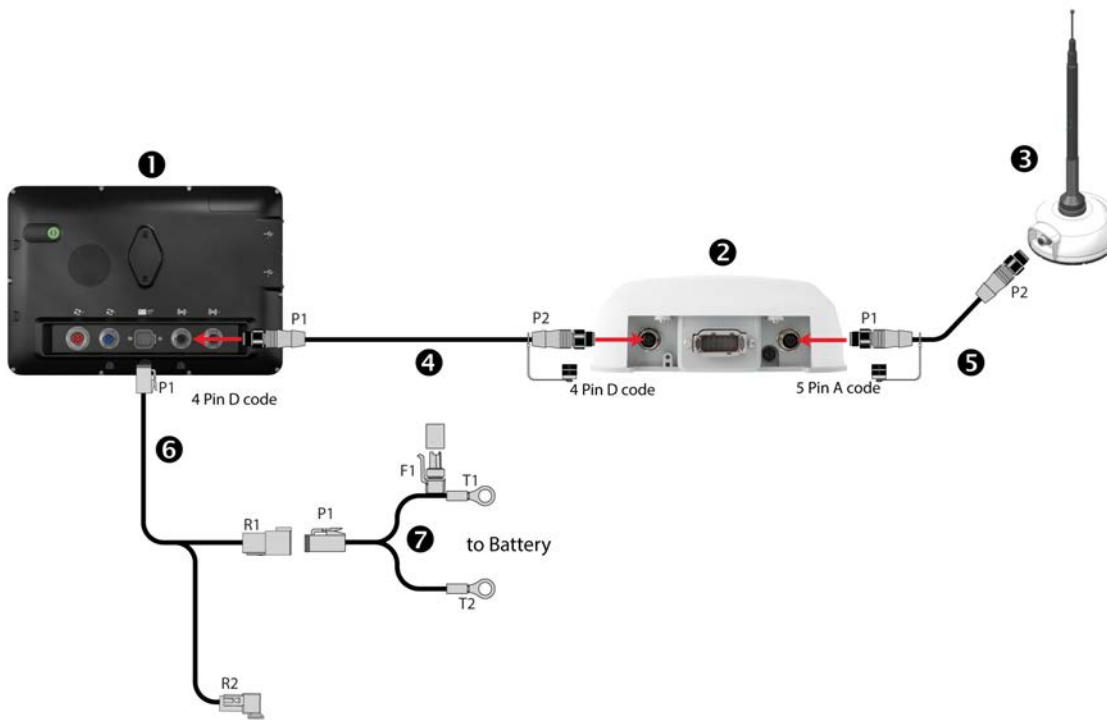

Item	Description	P/N
1	GFX/XCN series displays with PIQ app	
2	NAV-900 Guidance controller only	
3	Ag-820 radio	
4	Cable Assy, GFX/XCN to NAV-500/900, Power/Ethernet (BRR), 5 m	110540
5	Cable Assy, NAV-900 to Ag-820	113295
6	Cable Assy, GFX/XCN, Power to display, CAN, 2.5 m	110551
7	Cable Assy, GFX/CFX/FM-750/XCN/FMX/FM-1000 Basic Power, 4 m	67258
8	Cable Assy, GFX/XCN, Expansion Port Basic, RS232, Dig I/O, 2.5 m	110545

2.28 External RTK radio with NAV-900 guidance controller

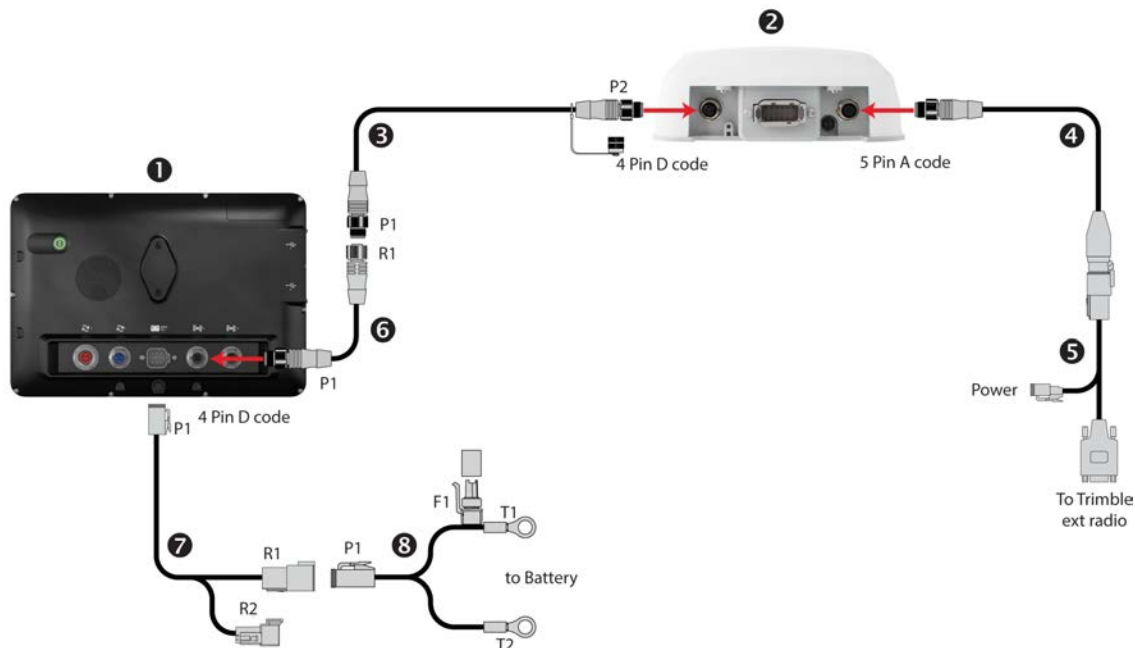

Item	Description	P/N
1	GFX/XCN series displays with PIQ app	
2	NAV-900 Guidance controller only	
3	Cable Assy, GFX/XCN to NAV-500/900, Power/Ethernet (BRR), 5 m	110540
4	Cable Assy, NAV-900 to in-cab RTK Radio, DTM06, 4.5 m	110544
5	Cable Assy, NAV-900, RTK Radio, DTM06 to DE9, Adapter	113633
6	Cable Assy, GFX/XCN to NAV-500/900, Power/Ethernet (BRR) Extension, 2.5 m. Optional extension for large vehicles.	112082
7	Cable Assy, GFX/XCN, Power to display, CAN, 2.5 m	110551
8	Cable Assy, GFX/CFX/FM-750/XCN/FMX/FM-1000 Basic power, 4 m	67258

